

# UNITS 111-114 8952 HOLT ROAD

SURREY, BC



## 13,160 SF AVAILABLE



**Kevin Volz**  
Personal Real Estate Corporation  
Vice President, Industrial  
+1 604 640 5851  
kevin.volz@cushwake.com

**Jot Mattu**  
Senior Associate, Industrial  
+1 604 639 9352  
jot.mattu@cushwake.com

**Rick Dhanda**  
Associate Vice President, Industrial  
+1 604 640 5816  
rick.dhanda@cushwake.com

**Andrew Green**  
Personal Real Estate Corporation  
Vice President, Industrial  
+1 604 640 5800  
andrew.green@cushwake.com

# UNITS 111-114 8952 HOLT ROAD

## SURREY, BC



### LOCATION

The subject property is located off of Scott Road and 88th Avenue, adjacent to BC Hydro and the Pacific Press properties. Excellent access is provided to Scott Road, 88th Avenue, Nordel Way, the Pattullo and the Alex Fraser Bridges. Excellent access is provided to Scott Road, 88th Avenue, Nordel Way, the Pattullo and the Alex Fraser Bridges.

### BUILDING FEATURES

- Concrete tilt-up construction
- Multi-tenant complex
- Fully Sprinklered
- Metal halide lighting
- Forced air gas warehouse heaters
- Min 23' ceilings in warehouse
- Covered dock loading with levelers
- Grade loading
- On-site parking
- Professionally managed by Canreal Management Corporation

### ZONING

I-L (Light Impact Industrial)

Allows for a wide range of light industrial uses such as manufacturing, warehousing, distribution and storage uses.

### BASIC LEASE RATE

From \$19.00 PSF, per annum, net, plus

### ADDITIONAL RENT (2025)

Estimated at \$5.45 PSF, per annum & 5% management fee (on gross rent), plus GST

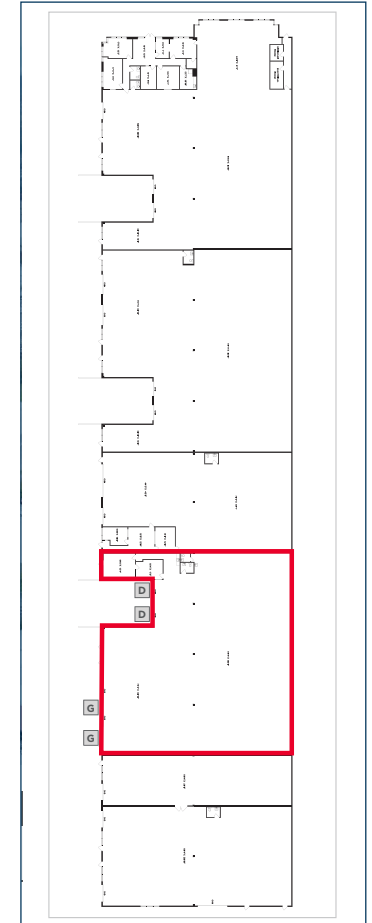

UNIT	WAREHOUSE AREA	OFFICE AREA	TOTAL AREA	LOADING DOORS	COMMENTS
111 - 114	12,607 SF	553	13,160 SF	2 Grade & 2 Dock	January 1, 2025

### FOR MORE INFORMATION, PLEASE CONTACT:

**Kevin Volz**  
Personal Real Estate Corporation  
Vice President, Industrial  
+1 604 640 5851  
kevin.volz@cushwake.com

**Jot Mattu**  
Senior Associate, Industrial  
+1 604 639 9352  
jot.mattu@cushwake.com

**Rick Dhanda**  
Associate Vice President, Industrial  
+1 604 640 5816  
rick.dhanda@cushwake.com

**Andrew Green**  
Personal Real Estate Corporation  
Vice President, Industrial  
+1 604 640 5800  
andrew.green@cushwake.com

Suite 1200 - 700 W Georgia St  
Vancouver, BC  
+1 604 683 3111  
[cushmanwakefield.com](http://cushmanwakefield.com)