



FOR LEASE
174 WYATT ROAD - WINNIPEG, MB

Murray Goodman
Senior Vice President & Principal
T 204 928 5009
C 204 990 4800
murray.goodman@cwstevenson.ca

Cushman & Wakefield | Stevenson
200 - 55 Donald Street
Winnipeg, Manitoba R3C 1L8
T 204 928 5000
www.cwstevenson.ca





PROPERTY HIGHLIGHTS

(+/-) 2,940 SF OF INDUSTRIAL SPACE

- Located in North West Winnipeg on Mandalay Drive & Wyatt Road. In the heart of Inkster Industrial Park, this unit is in close proximity to major transportation routes.
- Close to many amenities
- Unit includes 2 offices and 2 washrooms
- 1 dock level loading door
- (+/-) 15' ceiling
- Good Power
- Zoned M2
- Utilities extra
- Available May 1, 2025

LEASE RATE: \$9.95 NET PSF

CAM & TAX: \$4.06 (2024 EST.)



SITE PLAN

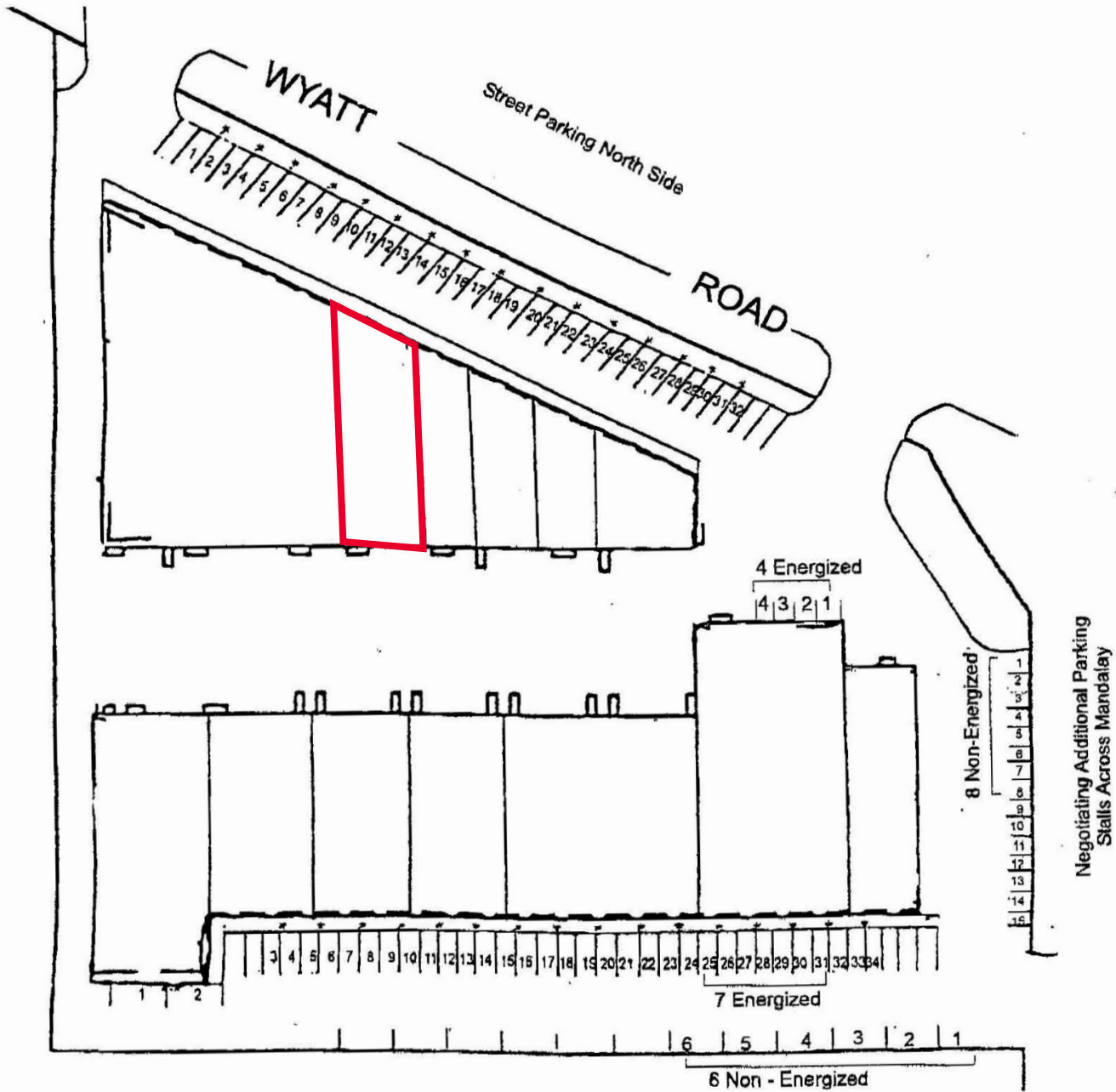

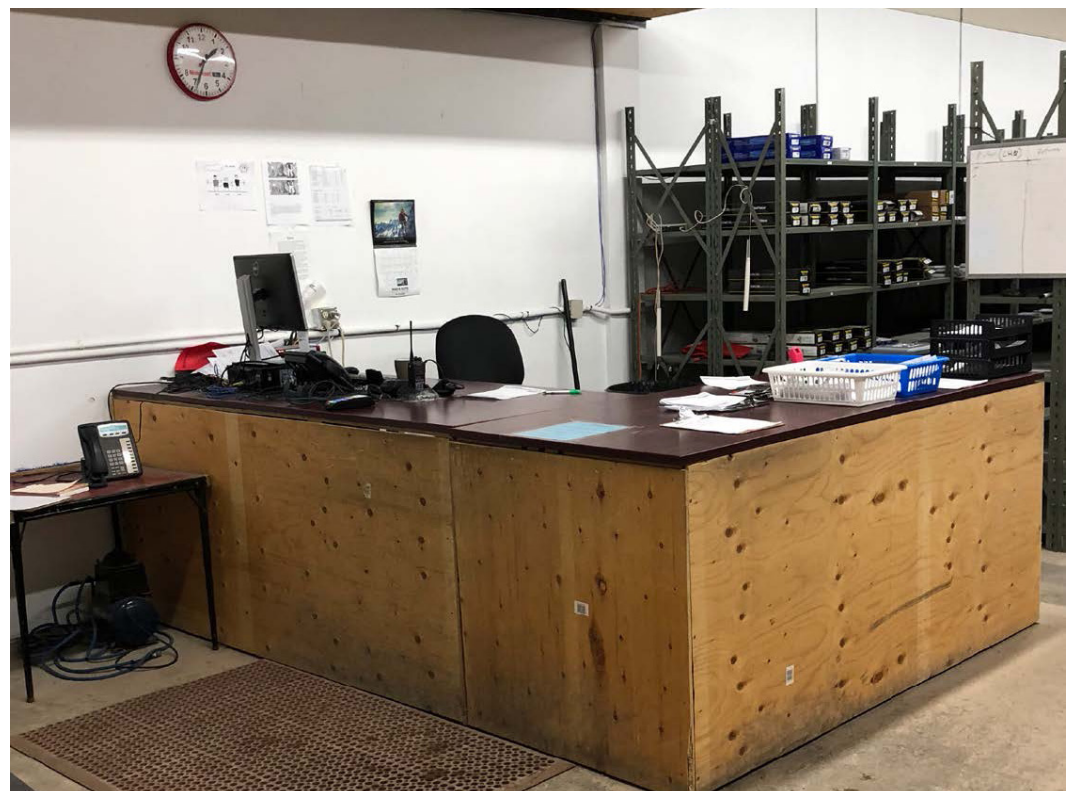

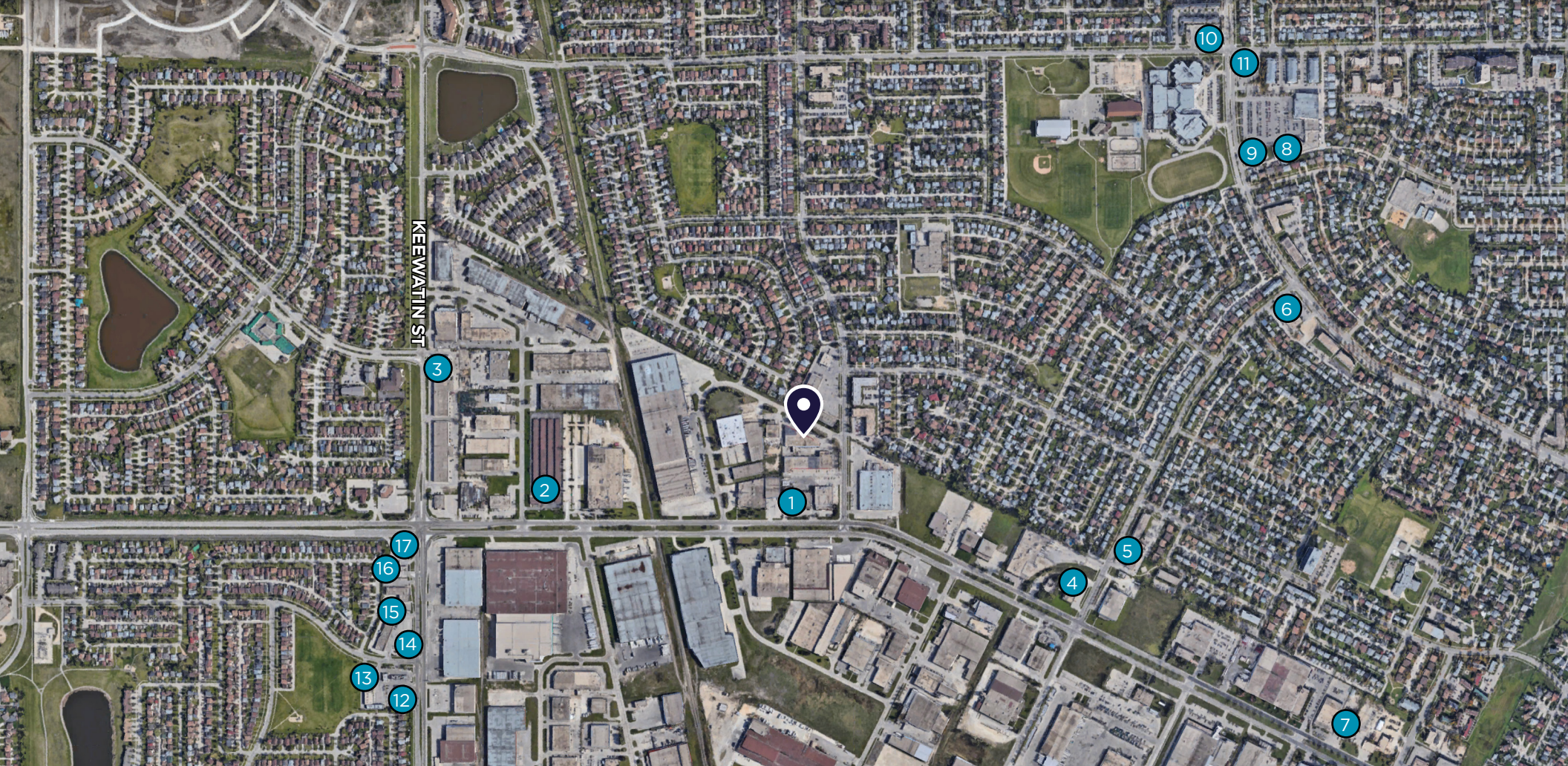

LOCAL AMENITIES

- 1 U-HAUL
- 2 ACCESS STORAGE
- 3 GREEN DROP LAWNS
- 4 TIM HORTONS
- 5 JOHNNY'S MAPLES PIZZA

- 6 7-11
- 7 GILL'S SUPERMARKET
- 8 DOLLARAMA
- 9 CHUNGCHUN RICE DOG
- 10 SHELL
- 11 ASSINIBOINE CREDIT UNION

- 12 MCDONALD'S
- 13 TANDOOR HOUSE
- 14 NATION WEST INSURANCE
- 15 KFC
- 16 RBC ROYAL BANK ATM
- 17 PETRO-CANADA



CONTACT

Murray Goodman
Senior Vice President & Principal
T 204 928 5009
C 204 990 4800
murray.goodman@cwstevenson.ca



Independently Owned and Operated / A Member of the Cushman & Wakefield Alliance ©2024 Cushman & Wakefield. All rights reserved. The information contained in this communication is strictly confidential. This information has been obtained from sources believed to be reliable but has not been verified. NO WARRANTY OR REPRESENTATION, EXPRESS OR IMPLIED, IS MADE AS TO THE CONDITION OF THE PROPERTY (OR PROPERTIES) REFERENCED HEREIN OR AS TO THE ACCURACY OR COMPLETENESS OF THE INFORMATION CONTAINED HEREIN, AND SAME IS SUBMITTED SUBJECT TO ERRORS, OMISSIONS, CHANGE OF PRICE, RENTAL OR OTHER CONDITIONS, WITHDRAWAL WITHOUT NOTICE, AND TO ANY SPECIAL LISTING CONDITIONS IMPOSED BY THE PROPERTY OWNER(S). ANY PROJECTIONS, OPINIONS OR ESTIMATES ARE SUBJECT TO UNCERTAINTY AND DO NOT SIGNIFY CURRENT OR FUTURE PROPERTY PERFORMANCE.