

**AVAILABLE FOR LEASE**



# 16726 SLOVER AVE | FONTANA, CA

±39,640 SF Industrial Building



**Kyle Kehner, SIOR**  
909 942 4645  
kyle.kehner@cushwake.com  
CA Lic. #01239566

**Tim Pimentel, SIOR**  
909 942 4647  
tim.pimentel@cushwake.com  
CA Lic. #01421452

**Chris Pimentel**  
909 942 4600  
chris.pimentel@cushwake.com  
CA Lic. #02207362

**Grant Arthur**  
909 942 4669  
grant.arthur@cushwake.com  
CA Lic. #02064730

# BUILDING HIGHLIGHTS



**±39,640 SF**

BUILDING  
FOR LEASE

**±2,533 SF**

OFFICES, PLUS  
±2,533 SF MEZZANINE

**32'**

CLEAR HEIGHT

**1,600**

AMPS  
3 PHASE POWER

**3**

DOCK  
DOORS

**1**

GRADE LEVEL  
RAMP

**135'**

FULLY SECURED  
TRUCK COURT

**17**

AUTO  
PARKING

up to **1000 MBps**

FIBER OPTIC  
AVAILABLE



**135' FULLY SECURED  
TRUCK COURT**

# 16726 SLOVER AVE | FONTANA, CA

## SITE PLAN

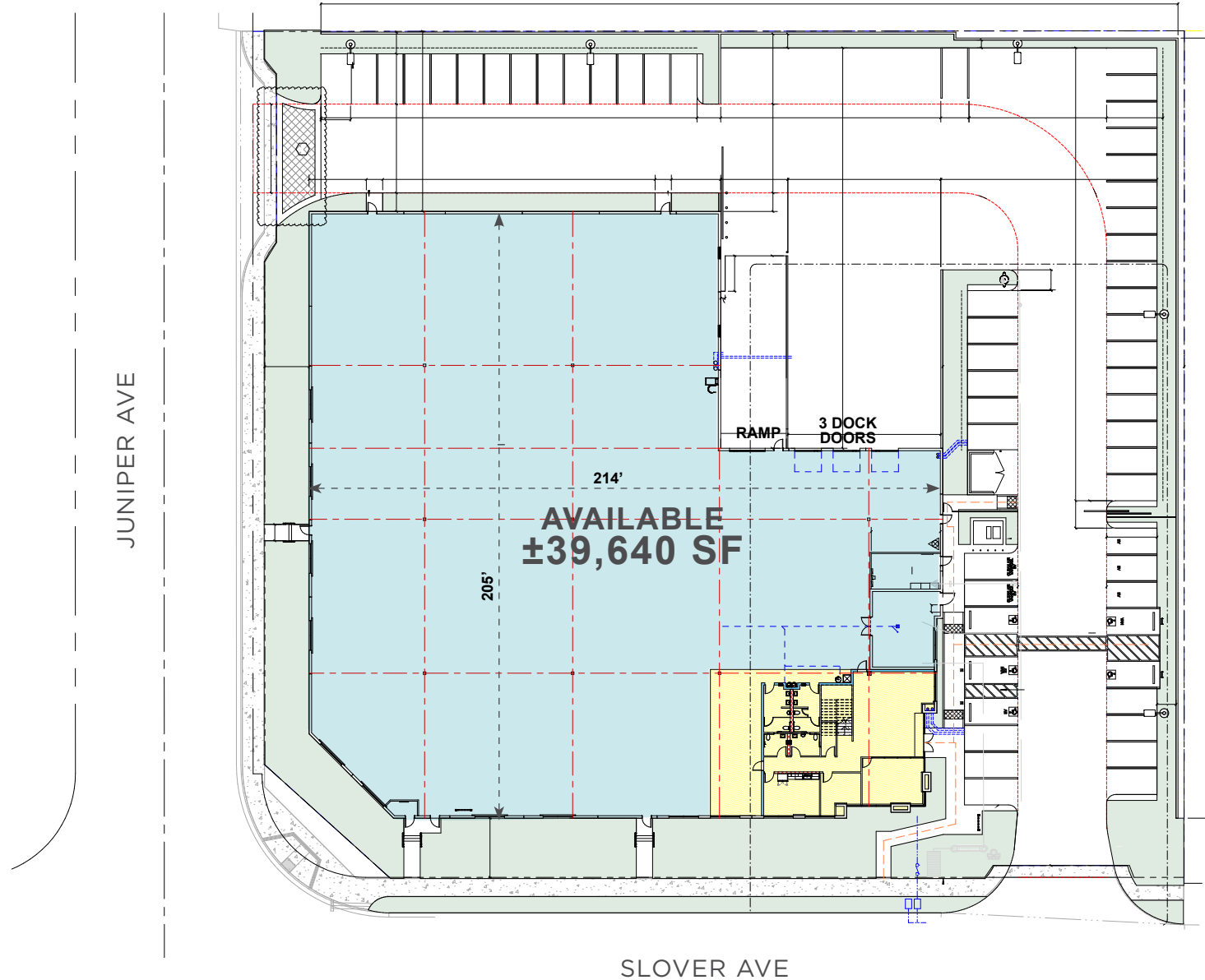

# 16726 SLOVER AVE | FONTANA, CA

## CONCEPTUAL RACKING PLAN



### 32' CLEAR HEIGHT

37,107 SQFT

Number of Bays	Pallet Height	Pallet Positions
278	54"	3,336
	68"	2,780
	88"	2,224

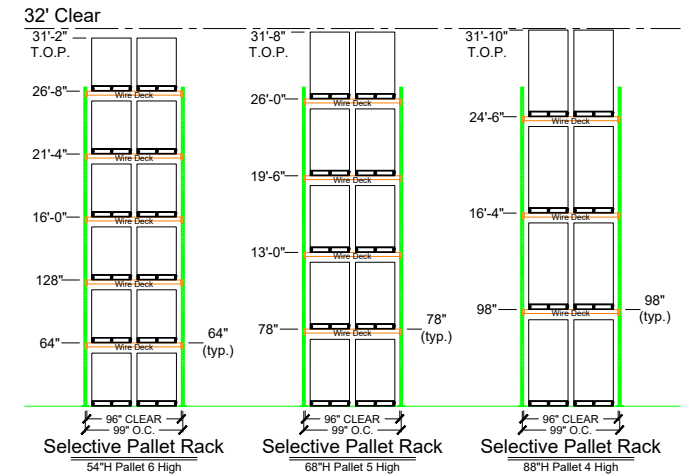

7351 Garden Grove Boulevard, Unit B • Garden Grove, CA 92841  
 Cell: (714) 743-4144 • Email: jmcghee@catalinais.com

Fluent in  
**Mandarin**  
 國語流利

# 16726 SLOVER AVE | FONTANA, CA

## LOCATION MAP

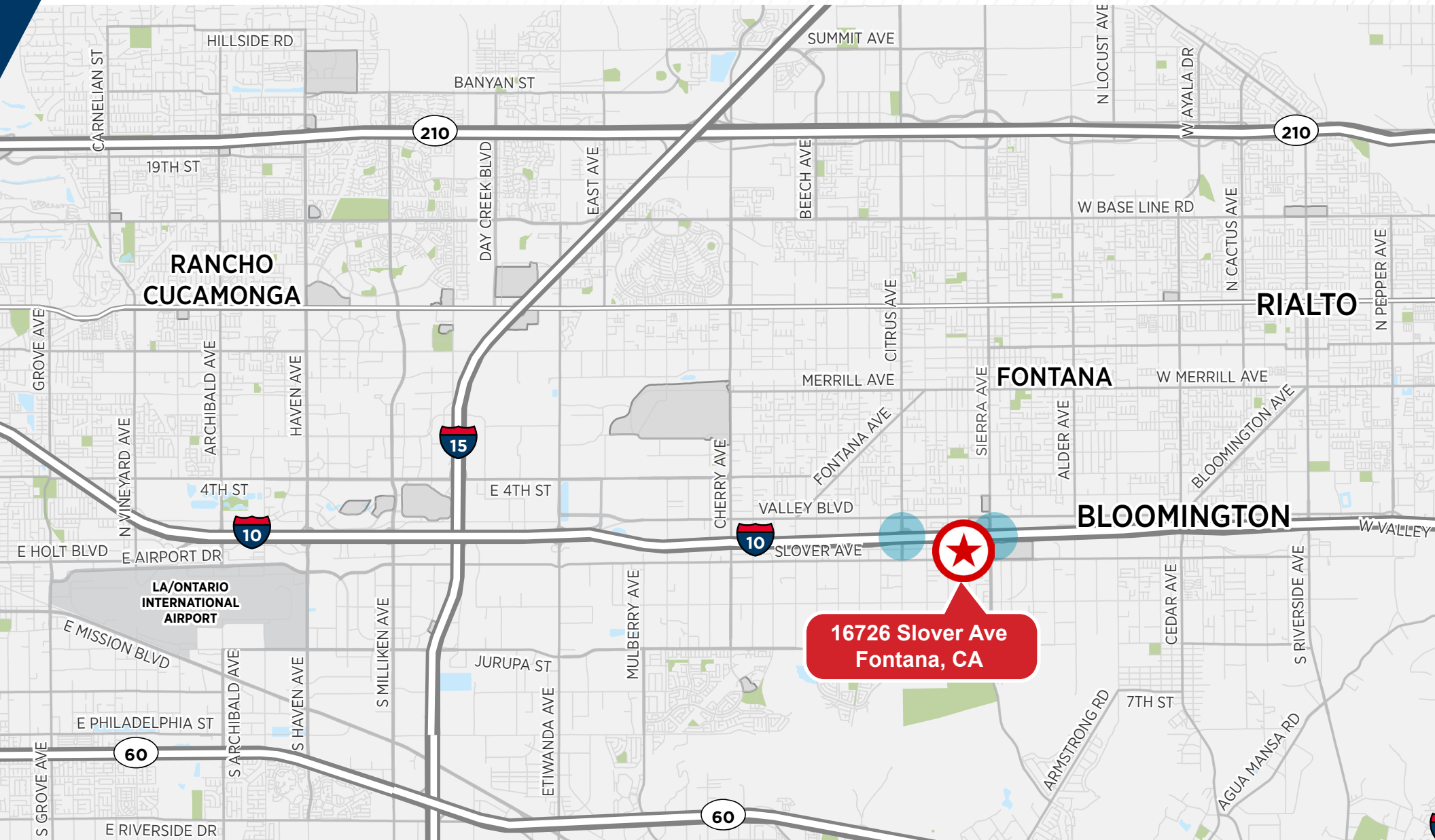

16726 Slover Ave  
Fontana, CA



FOR MORE INFORMATION, PLEASE CONTACT:

**Kyle Kehner, SIOR**  
909 942 4645  
kyle.kehner@cushwake.com  
CA Lic. #01239566

**Tim Pimentel, SIOR**  
909 942 4647  
tim.pimentel@cushwake.com  
CA Lic. #01421452

**Chris Pimentel**  
909 942 4600  
chris.pimentel@cushwake.com  
CA Lic. #02207362

**Grant Arthur**  
909 942 4669  
grant.arthur@cushwake.com  
CA Lic. #02064730



©2024 Cushman & Wakefield. All rights reserved. The information contained in this communication is strictly confidential. This information has been obtained from sources believed to be reliable but has not been verified. NO WARRANTY OR REPRESENTATION, EXPRESS OR IMPLIED, IS MADE AS TO THE CONDITION OF THE PROPERTY (OR PROPERTIES) REFERENCED HEREIN OR AS TO THE ACCURACY OR COMPLETENESS OF THE INFORMATION CONTAINED HEREIN, AND SAME IS SUBMITTED SUBJECT TO ERRORS, OMISSIONS, CHANGE OF PRICE, RENTAL OR OTHER CONDITIONS, WITHDRAWAL WITHOUT NOTICE, AND TO ANY SPECIAL LISTING CONDITIONS IMPOSED BY THE PROPERTY OWNER(S). ANY PROJECTIONS, OPINIONS OR ESTIMATES ARE SUBJECT TO UNCERTAINTY AND DO NOT SIGNIFY CURRENT OR FUTURE PROPERTY PERFORMANCE.

