



2ND FLOOR OFFICE - DOWNTOWN MERIDIAN



# GENERATIONS PLAZA OFFICE

114 East Idaho Avenue  
Meridian, Idaho 83642

484 SF - FOR LEASE

## PROPERTY HIGHLIGHTS

Suite 220	484 SF
Lease Rate	\$22.00/SF FSEJ
Building Size	7,080 SF Total
Year Built	2001
Parcel Size	0.08 Acres
Zoning	City of Meridian-O-T
Parcel #	R5672000731
Availability	12/1/2024
LockBox	No, Please Do Not Disturb Current Tenant, Contact Agents



**BREE WELLS**  
Director  
Office | Capital Markets  
+1 208 287 9492  
bree.wells@cushwake.com

**JENNIFER MCENTEE**  
Senior Director  
Office | Capital Markets  
+1 208 287 9495  
jennifer.mcentee@cushwake.com

**BRAYDON TORRES**  
Associate  
Office | Capital Markets  
+1 208 207 9485  
braydon.torres@cushwake.com

999 W MAN ST. SUITE 1300, BOISE, IDAHO 83702  
[CUSHMANWAKEFIELD.COM](http://CUSHMANWAKEFIELD.COM)

©2024 Cushman & Wakefield. All rights reserved. The information contained in this communication is strictly confidential. This information has been obtained from sources believed to be reliable but has not been verified. No warranty or representation, express or implied, is made as to the condition of the property (or properties) referenced herein or as to the accuracy or completeness of the information contained herein, and same is submitted subject to errors, omissions, change of price, rental or other conditions, withdrawal without notice, and to any special listing conditions imposed by the property owner(s). Any projections, opinions or estimates are subject to uncertainty and do not signify current or future property performance.

# GENERATIONS PLAZA I OFFICE SPACE

114 East Idaho Avenue, Meridian, Idaho 83642

FOR LEASE - 484 SF - \$22.00/SF FSEJ



## FLOOR PLAN

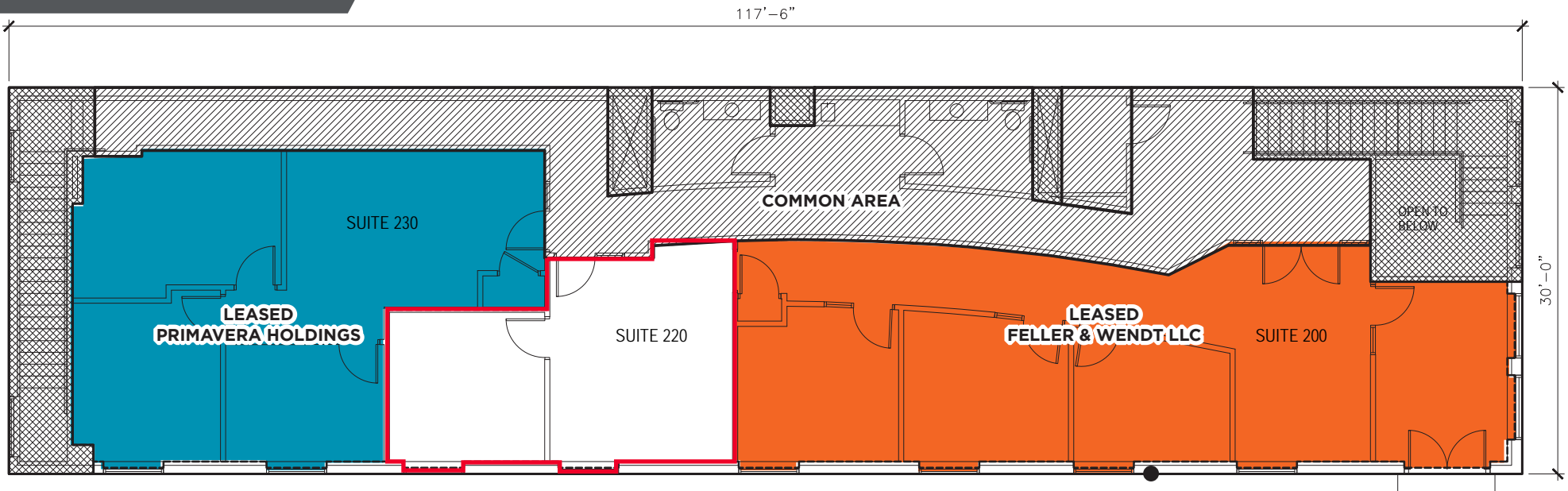

## LISTING FEATURES

- Second floor move-in ready office space in downtown Meridian at Main Street & Idaho Avenue
- Suite 220 consists of 1 private office and an open work area / waiting room
- Available suite was recently updated with new paint and in good condition
- Mixed-use building with common area entries, kitchenette and restrooms
- High downtown Meridian visibility with Idaho Avenue frontage & on-site shared parking
- Walking distance to restaurants & surrounding services - [Google 360 View](#)
- Please do not disturb relocating tenant, contact agents to schedule a walkthrough today!!



**CUSHMAN &  
WAKEFIELD**

# GENERATIONS PLAZA

114 East Idaho Avenue, Meridian, Idaho 83642

**FOR LEASE - 484 SF - \$22.00/SF FSEJ**



## LISTING PHOTOS



### BREE WELLS

Director  
Office | Capital Markets  
+1 208 287 9492  
bree.wells@cushwake.com

### JENNIFER MCENTEE

Senior Director  
Office | Capital Markets  
+1 208 287 9495  
jennifer.mcentee@cushwake.com

### BRAYDON TORRES

Associate  
Office | Capital Markets  
+1 208 207 9485  
braydon.torres@cushwake.com

### 999 W Main Street, Ste 1300

Boise, Idaho 83702  
Main +1 208 287 9500  
Fax +1 208 287 9501  
cushmanwakefield.com

# GENERATIONS PLAZA | OFFICE SPACE

114 East Idaho Avenue, Meridian, Idaho 83642

FOR LEASE - 484 SF - \$22.00/SF FSEJ



## DOWNTOWN MERIDIAN LOCATION

