

# 2526 FAIRWAY PARK DRIVE

2500-2530 FAIRWAY PARK DRIVE, HOUSTON, TX 77092



**20,417 SF | FOR LEASE**

The property 2500 - 2530 Fairway Park Drive is a well-located warehouse facility within close proximity to Loop 610. This facility is situated between 290 and Hempstead Highway and is ideal for distribution in Houston's northwest corridor.

## PROPERTY SPECIFICATIONS

Available Space:	20,417 SF
Office Space:	1,060 SF
Warehouse Space:	19,357 SF
Submarket:	Northwest Houston
Ceiling Height:	22
Dock High Doors:	3
Ramps:	1
Zoning:	N/A

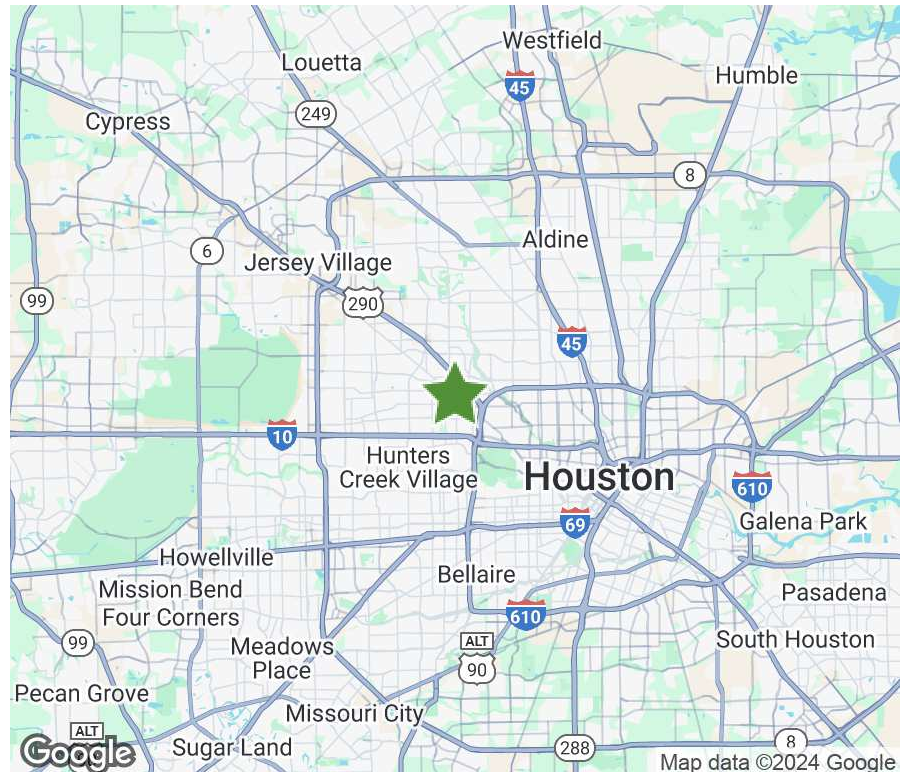

# 2526 FAIRWAY PARK DRIVE

20,417 SF | FOR LEASE

## FLOOR PLAN

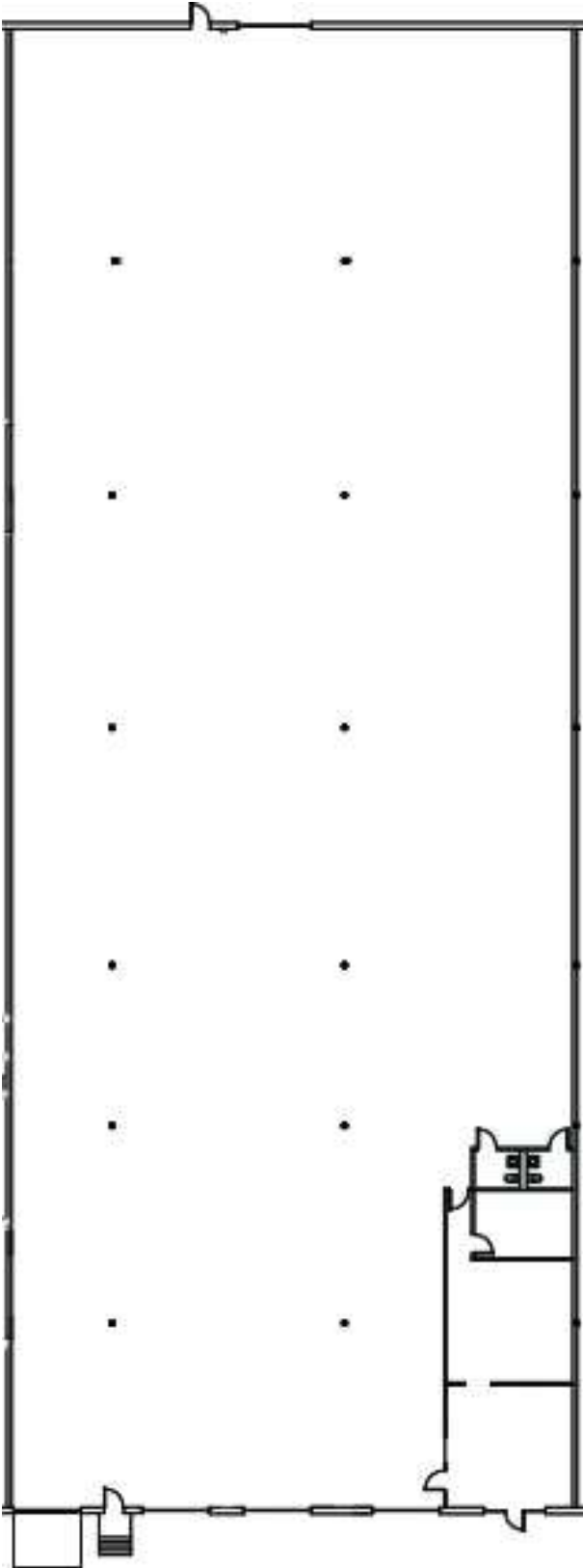

### BROKER CONTACT

#### David Munson, SIOR

Cushman & Wakefield  
713.913.5473  
david.munson@cushwake.com

#### Garrett Thomas

Cushman & Wakefield  
713.260.0244  
garrett.thomas@cushwake.com



---

### OWNER CONTACT

#### Jake Allen

Regional Manager  
312.344.4331  
jallen@firstindustrial.com



1225 North Loop West, Suite 700

Houston, TX 77008

713.681.0885

All information furnished regarding the property for sale, rental or financing is obtained from sources deemed reliable. No representation is made to the accuracy thereof and is submitted subject to errors, omissions, change of price rental or other conditions, prior sale, lease, or financing, or withdrawal without notice. First Industrial Realty Trust, Inc. represents the Seller in this transaction and as such owes all duties and obligations thereto.