

CUSHMAN &
WAKEFIELD

FOR SUBLEASE
30,726 SF AVAILABLE

11525 MAIN ST.

BROOMFIELD, CO 80020





CLICK HERE FOR VIRTUAL TOUR

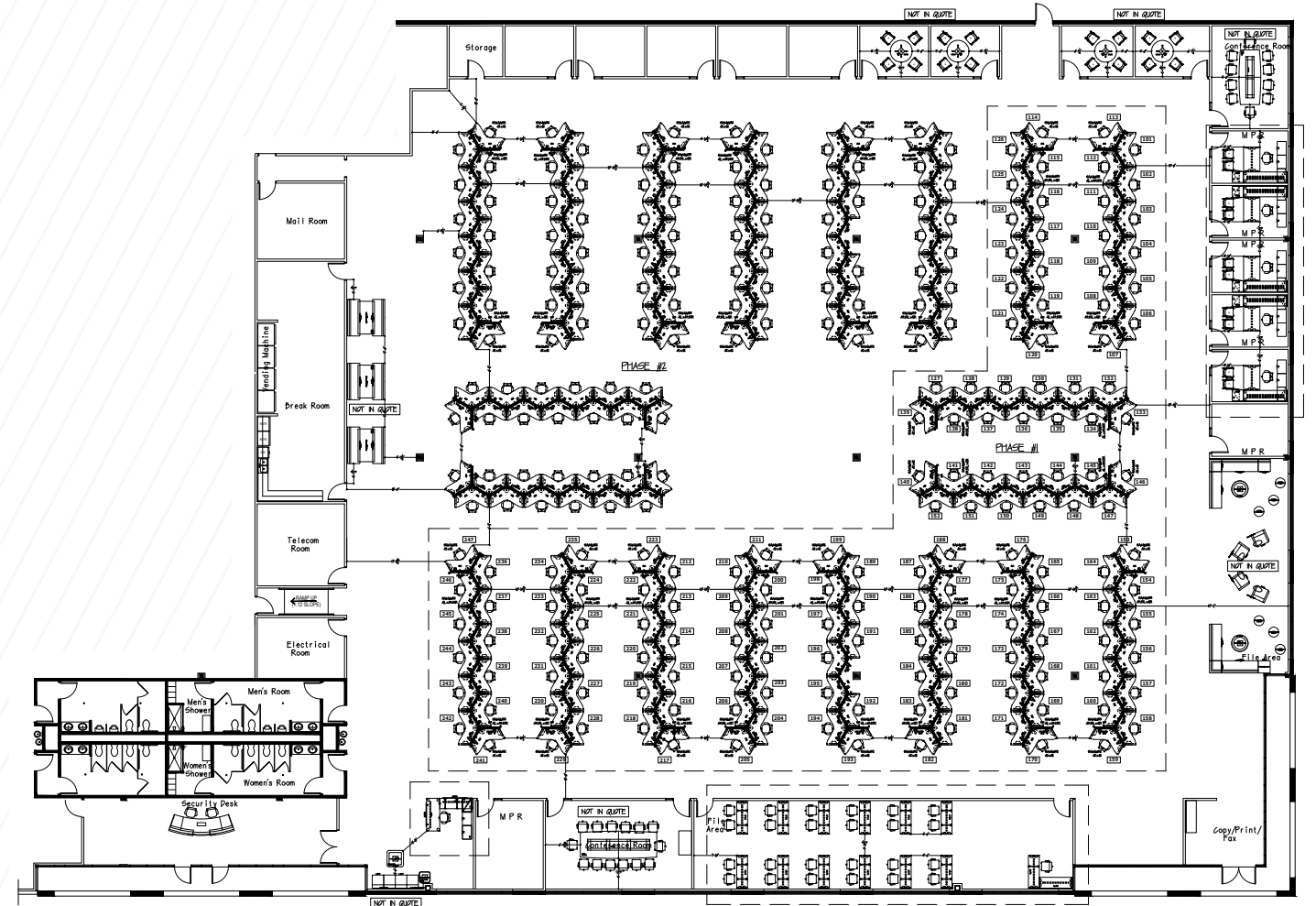

Property Features

- Availability** 30,726 SF Available Now
- Term** Through May 31, 2027
- Configuration** ±260 Workstations
±14 Private Offices/Huddle Rooms
±3 Conference Rooms
- Sublease Rate** Negotiable
- Furniture** Available
- Parking** 175 Spaces | 5.65 : 1,000 SF

Property Highlights

- 18' to 24' ceilings, large truck courts, dock-high and drive-in loading and numerous appealing amenities for warehousing and flex users
- Located in the booming Boulder Turnpike corridor with easy access to Highway 36

30,726 SF Available

- ±260 Workstations
- ±14 Private Offices/Huddle Rooms
- ±3 Conference Rooms





STEVE BILLIGMEIER

Vice Chairman

+1 303 813 6413

steve.billigmeier@cushwake.com

SID DIXON

Director

+1 303 312 4273

sidney.dixon@cushwake.com

©2022 Cushman & Wakefield. All rights reserved. The information contained in this communication is strictly confidential. This information has been obtained from sources believed to be reliable but has not been verified. NO WARRANTY OR REPRESENTATION, EXPRESS OR IMPLIED, IS MADE AS TO THE CONDITION OF THE PROPERTY (OR PROPERTIES) REFERENCED HEREIN OR AS TO THE ACCURACY OR COMPLETENESS OF THE INFORMATION CONTAINED HEREIN, AND SAME IS SUBMITTED SUBJECT TO ERRORS, OMISSIONS, CHANGE OF PRICE, RENTAL OR OTHER CONDITIONS, WITHDRAWAL WITHOUT NOTICE, AND TO ANY SPECIAL LISTING CONDITIONS IMPOSED BY THE PROPERTY OWNER(S). ANY PROJECTIONS, OPINIONS OR ESTIMATES ARE SUBJECT TO UNCERTAINTY AND DO NOT SIGNIFY CURRENT OR FUTURE PROPERTY PERFORMANCE.

