



PRIME COMMERCIAL/RETAIL/OFFICE/SPA SPACE AVAILABLE | **FOR LEASE**

620
RICHMOND
STREET
UNIT G

London, ON N6A 5J9



**CUSHMAN &
WAKEFIELD**

Southwestern Ontario

ABOUT THE PROPERTY

Prime downtown corner building available for lease on Richmond Row

UNIT	AVAILABLE SPACE	ASKING NET RENT	ADDITIONAL RENT
G	Approx. 929 SF	\$25.00 PSF Net escalating	\$13.93 PSF (Est.) + Utilities +HST

- Zoning: BDC(1)** - permits a wide range of uses such as, retail, offices, restaurants, medical/dental/clinics, financial, bake shops, service and repair, convenience stores, food store, studios, commercial recreation, personal service establishments etc
- Across from Victoria Park, Starbucks, Joe Kools, Libro, located beside the Running Room, Andrew Douglas Clothier and Katsuya restaurant
- Excellent street exposure
- High daily traffic count

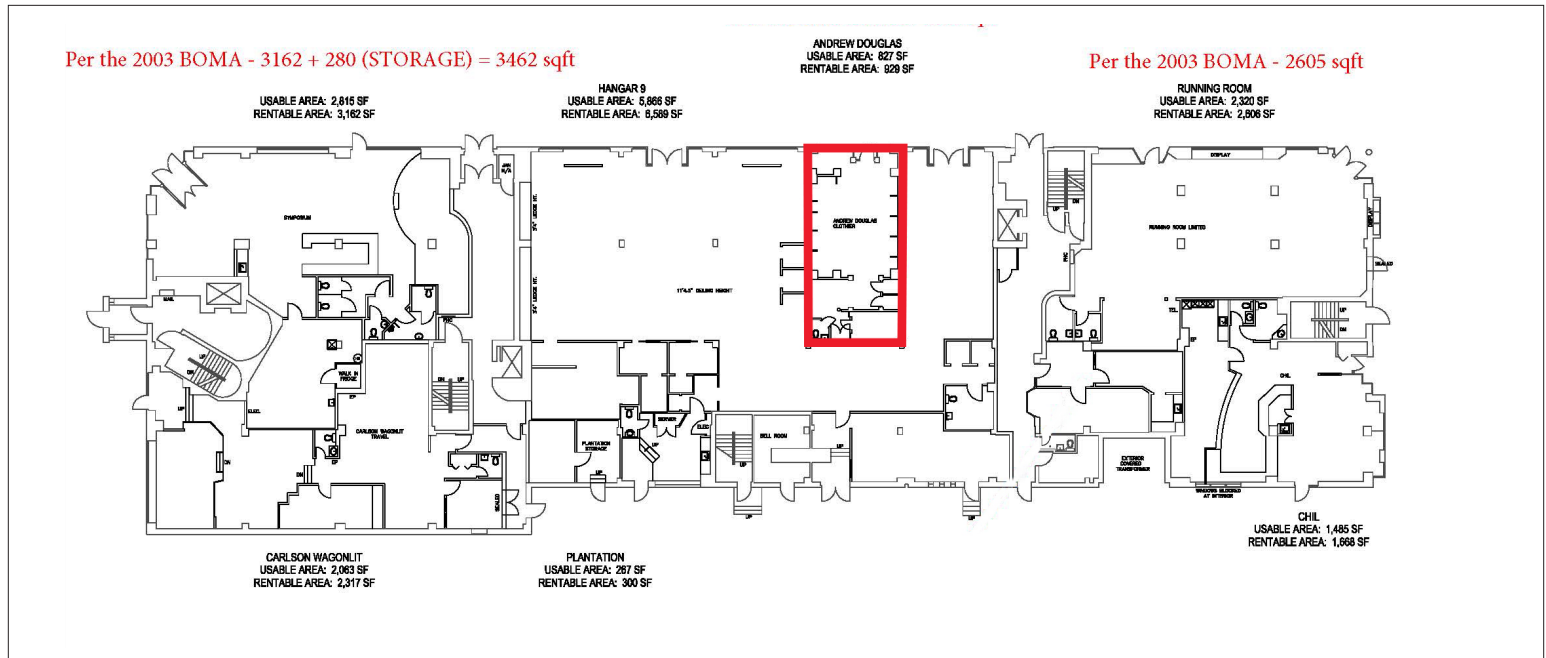

TYLER DESJARDINE
Sales Representative
 519 438 5403
 tyler.desjardine@cushwakeswo.com

CUSHMAN & WAKEFIELD
 SOUTHWESTERN ONTARIO
 850 Medway Park Dr, Suite 201
 London, Ontario N6G 5C6
 www.cushwakeswo.com



©2025 Cushman & Wakefield Southwestern Ontario, Real Estate Brokerage, Independently Owned and Operated. A Member of the Cushman & Wakefield Alliance. This information has been obtained from sources believed to be reliable but has not been verified. No warranty or representation, express or implied, is made as to the condition of the property (or properties) referenced herein or as to the accuracy or completeness of the information contained herein, and same is submitted subject to errors, omissions, change of price, rental or other conditions, withdrawal without notice, and to any special listing conditions imposed by the property owner(s). Any projections, opinions or estimates are subject to uncertainty and do not signify current or future property performance. All rights reserved.