

FOR LEASE

**THE MARKET
AT CENTRE
IN THE PARK**

SWC of Festival Way
& Sherwood Drive
Sherwood Park, AB

**NEW MIXED USE
DEVELOPMENT WITH
PRIME MAIN FLOOR
RETAIL SPACE**

Cushman & Wakefield Edmonton
Suite 2700, TD Tower
10088 102 Avenue
Edmonton, AB T5J 2Z1
cwedm.com

Karina Lopez
Senior Associate
780 429 9393
karina.lopez@cwedm.com

Devan Ramage
Associate
780 702 9479
devan.ramage@cwedm.com

PROPERTY HIGHLIGHTS

- New 40,000 SF development located directly across from Sherwood Park Mall.
- Market at Centre in the Park is a unique mixed use residential and retail development. Pedestrian walkways on site will contribute to easy access for residents and patrons to the centre.
- Tenants at the site include: H&W Produce (Now Open!), Ribeye Butcher, Pharmacy, Barber Shop, Complete Denture Clinic, Medical Clinic, Amazing Nails and Code Ninjas.
- Flexible bay sizes available (1,297 SF and up) can accommodate for a variety of uses.
- Excellent visibility and exposure to Festival Way and Sherwood Drive.
- Sherwood Drive sees over 24,000 vehicles per day.



DEMOGRAPHICS

	POPULATION		
	1km	3km	5km
	5,000	51,384	83,071

	HOUSEHOLDS		
	1km	3km	5km
	1,978	18,795	29,680

	AVERAGE INCOME		
	1km	3km	5km
	\$131,780	\$162,411	\$169,215





PROPERTY DETAILS

BASIC RENT

Market

ADDITIONAL RENT

\$12.89 per SF (estimated for 2024) +
Landlords Administration Fee

PARKING

Above ground parking on site for customers

AVAILABLE SIZES

±1,297 SF and up

RESIDENTIAL

80 suites on site, fully leased

USES WANTED



Restaurants, quick service/fast foods & liquor store



Medical: Optometry, dentist, physiotherapist, hearing clinic, chiropractor, medical specialist, labs & x-ray



Financial, Insurance, financial institution, accounting, business services, registry & office



Florist, specialty sports, convenience store, jewelry and clothing boutique



Services: Hair salon, spa & fitness, dry cleaner & tailor

SITE PLAN

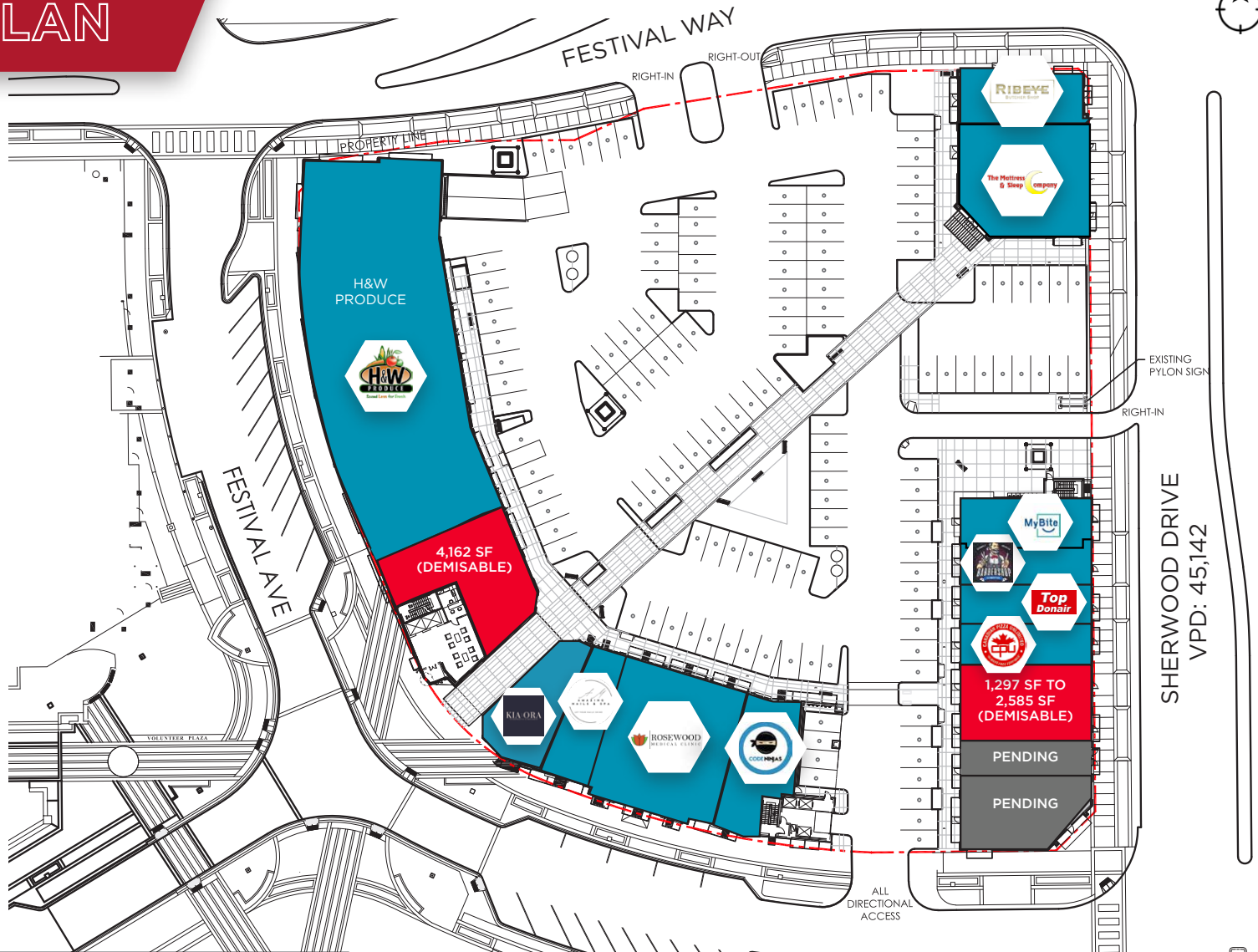

CUSHMAN & WAKEFIELD
Edmonton

Karina Lopez
Senior Associate
780 429 9393
karina.lopez@cwedm.com

Devan Ramage
Associate
780 702 9479
devan.ramage@cwedm.com