







**FOR LEASE**

19801-19821 85<sup>th</sup> Ave. South  
Kent, WA 98031

Building A



## Property Features

-  Over 1.7 MSF with flexible configurations
-  Strategically located with direct access to WA-167 (1 mile), I-5 (3 miles), and I-405 (4 miles)
-  Superior dock-high and grade-level heavy loading
-  Located in Kent Valley Submarket
-  24' Clear Height
-  M2 Zoning (City of Kent)
-  Rail Served by Burlington Northern



[Click to View A Video of the Property](#)

Owned By

**maple**tree

Leasing By

 **CUSHMAN & WAKEFIELD**

Scott Alan  
Executive Director  
+1 206 521 0236  
scott.alan@cushwake.com

Patrick Mullin  
Managing Director  
+1 206 521 0265  
patrick.mullin@cushwake.com

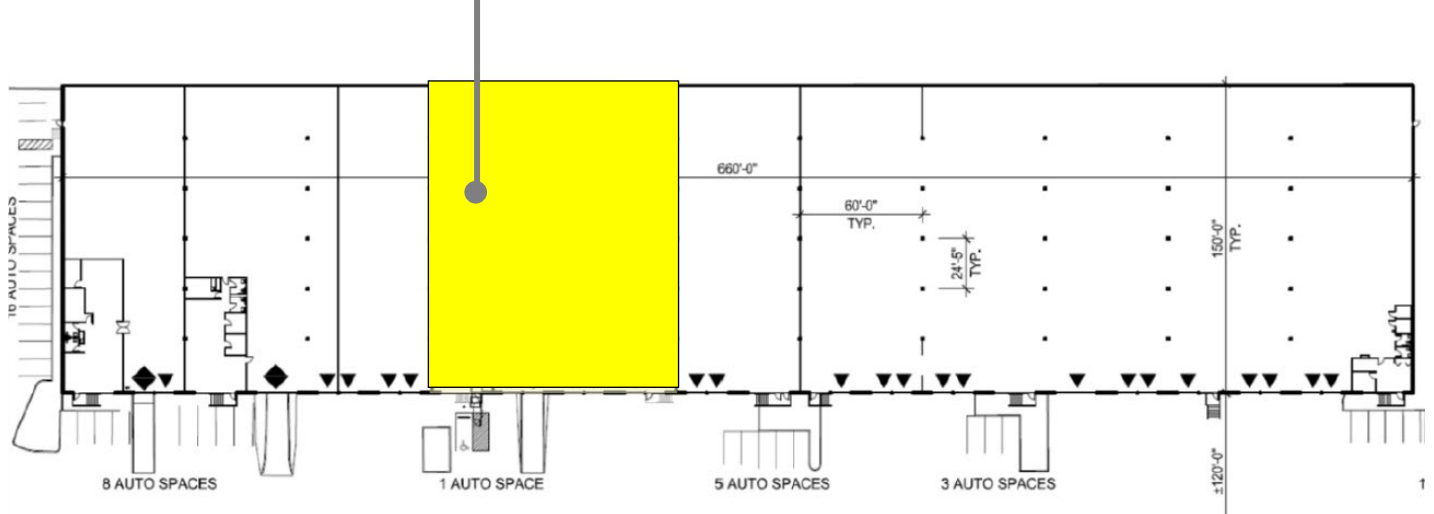
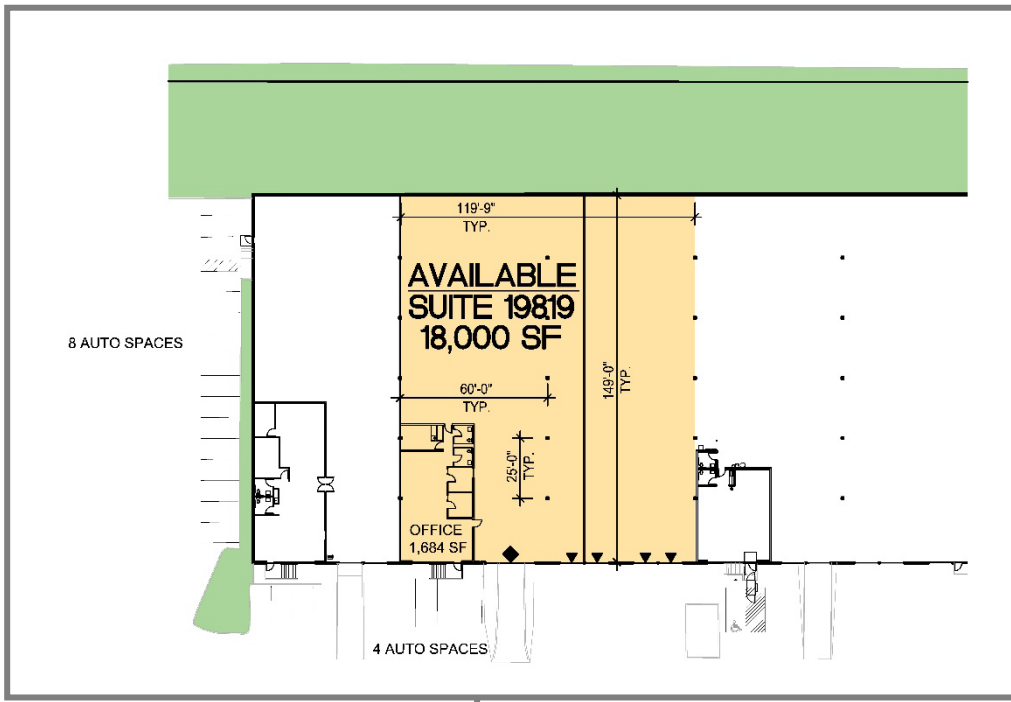

## Property Specifications

- » Space Available: 18,000 SF
- » Office Space: 1,685 SF
- » Dock High Doors: 5 with 3 levelers (8' x 9')
- » Drive-In Doors: 1 with ramp (8' x 9')
- » Column Spacing: 60' x 25'
- » Clear Height: 24'
- » Truck Court: 185' (North) and 168' (South)
- » Lighting: T-5 Motion Sensor
- » Configuration: The property supports both heavy logistics and manufacturing users in order to accommodate a variety of business needs.

Owned By

mapletree

Leasing By

 CUSHMAN & WAKEFIELD

Scott Alan

Executive Director

+1 206 521 0236

scott.alan@cushwake.com

Patrick Mullin

Managing Director

+1 206 521 0265

patrick.mullin@cushwake.com

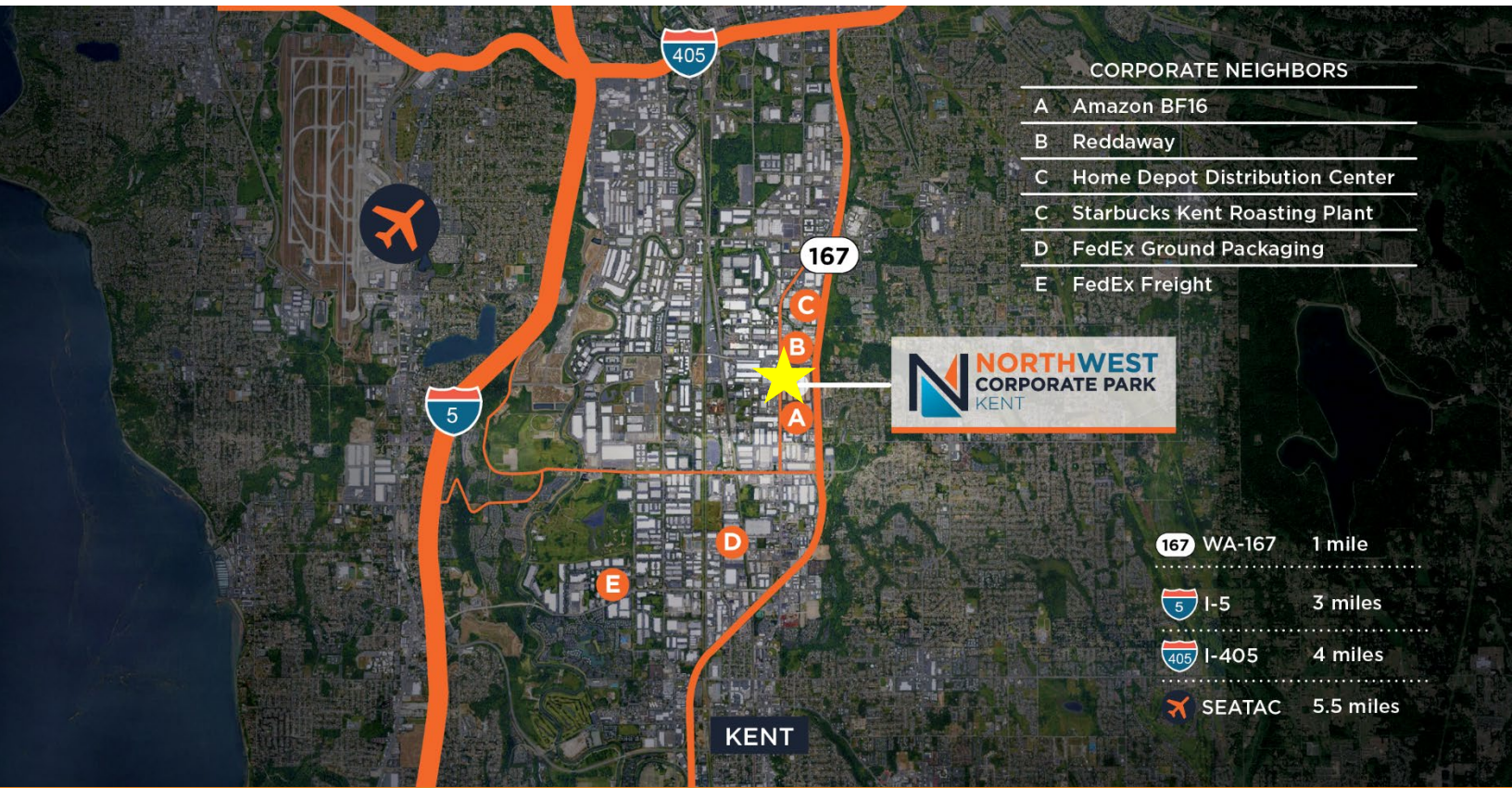

- CORPORATE NEIGHBORS**
- A Amazon BF16
  - B Reddaway
  - C Home Depot Distribution Center
  - C Starbucks Kent Roasting Plant
  - D FedEx Ground Packaging
  - E FedEx Freight



- WA-167 1 mile
- I-5 3 miles
- I-405 4 miles
- SEATAC 5.5 miles



Owned By

Leasing By

Scott Alan  
 Executive Director  
 +1 206 521 0236  
 scott.alan@cushwake.com

Patrick Mullin  
 Managing Director  
 +1 206 521 0265  
 patrick.mullin@cushwake.com

©2021 Cushman & Wakefield. All rights reserved. The information contained in this communication is strictly confidential. This information has been obtained from sources believed to be reliable but has not been verified. NO WARRANTY OR REPRESENTATION, EXPRESS OR IMPLIED, IS MADE AS TO THE CONDITION OF THE PROPERTY (OR PROPERTIES) REFERENCED HEREIN OR AS TO THE ACCURACY OR COMPLETENESS OF THE INFORMATION CONTAINED HEREIN, AND SAME IS SUBMITTED SUBJECT TO ERRORS, OMISSIONS, CHANGE OF PRICE, RENTAL OR OTHER CONDITIONS, WITHDRAWAL WITHOUT NOTICE, AND TO ANY SPECIAL LISTING CONDITIONS IMPOSED BY THE PROPERTY OWNER(S). ANY PROJECTIONS, OPINIONS OR ESTIMATES ARE SUBJECT TO UNCERTAINTY AND DO NOT SIGNIFY CURRENT OR FUTURE PROPERTY PERFORMANCE.