

**1250 E. 222<sup>nd</sup> Street**  
Euclid, Ohio 44117

**CONFIDENTIALITY AGREEMENT**



INDUSTRIAL INVESTMENT OPPORTUNITY  
**OFFERING PREVIEW**

TWO (2) TENANT 152,790 SQUARE FOOT INDUSTRIAL MANUFACTURING COMPLEX ON  
9.47 ACRES IN AN OPPORTUNITY ZONE



## Key Highlights

- 1250 E. 222nd Street, Euclid Ohio. Two (2) Tenant, 100% leased - 152,790 SF 17-crane industrial complex, heavy power (sub-station on property), two (2) docks, six (6) 14' x 16' drive-in doors, 30' clear ceiling heights, etc.

- Two long term tenants in place:

**Mechanical Dynamics & Analysis (MD&A):** Provides power generators around the globe with a full-service, OEM-alternative for services, parts, and repairs for Gas Turbines, Steam Turbines, Industrial Turbines, and Generators

**BONENG Transmission, USA:** A subsidiary of SUZHOU.CO LTD. A professional manufacturer of mechanical and electrical products integrating design, manufacturing, assembly, and sales services servicing the mining, metallurgy, chemical, cement, and power industries to name a few

- The property, being offered at substantially below replacement cost, has undergone non-stop renovations since 2015 continuing through fall of 2024. The renovations include (but not inclusive): roof repairs and replacements, updated and expanded electrical, exterior parking lot work, LED lighting, etc

## Specifications

1250 E. 222nd Street, Euclid, Ohio 44117	
<b>Year Built</b>	1957
<b>Building Size</b>	152,790 SF
<b>Acreage</b>	9.47 Acres
<b>Construction Type</b>	Masonry/Metal
<b>Roof</b>	TPO & EPDM
<b>Docks</b>	Two (2) - One (1) interior and one (1) exterior
<b>Drive-in Doors</b>	Two (2) - 12'x14' and 14'x14'
<b>Cranes</b>	17 - Three (3) 25-ton, one (1) 20-ton, one (1) 7.5-ton, three (3) 5-ton and nine (9) 2-ton
<b>Clear Height</b>	18' - 35'
<b>Sprinkler</b>	100% Wet
<b>Lighting</b>	LED and Fluorescent
<b>Heat</b>	Air-Rotation, Radiant Tube and OHD Gas
<b>Power</b>	Abundant including 1500 KVA sub-station on site. Extensive buss duct throughout
<b>Parking</b>	250 spaces

# FLOOR PLAN

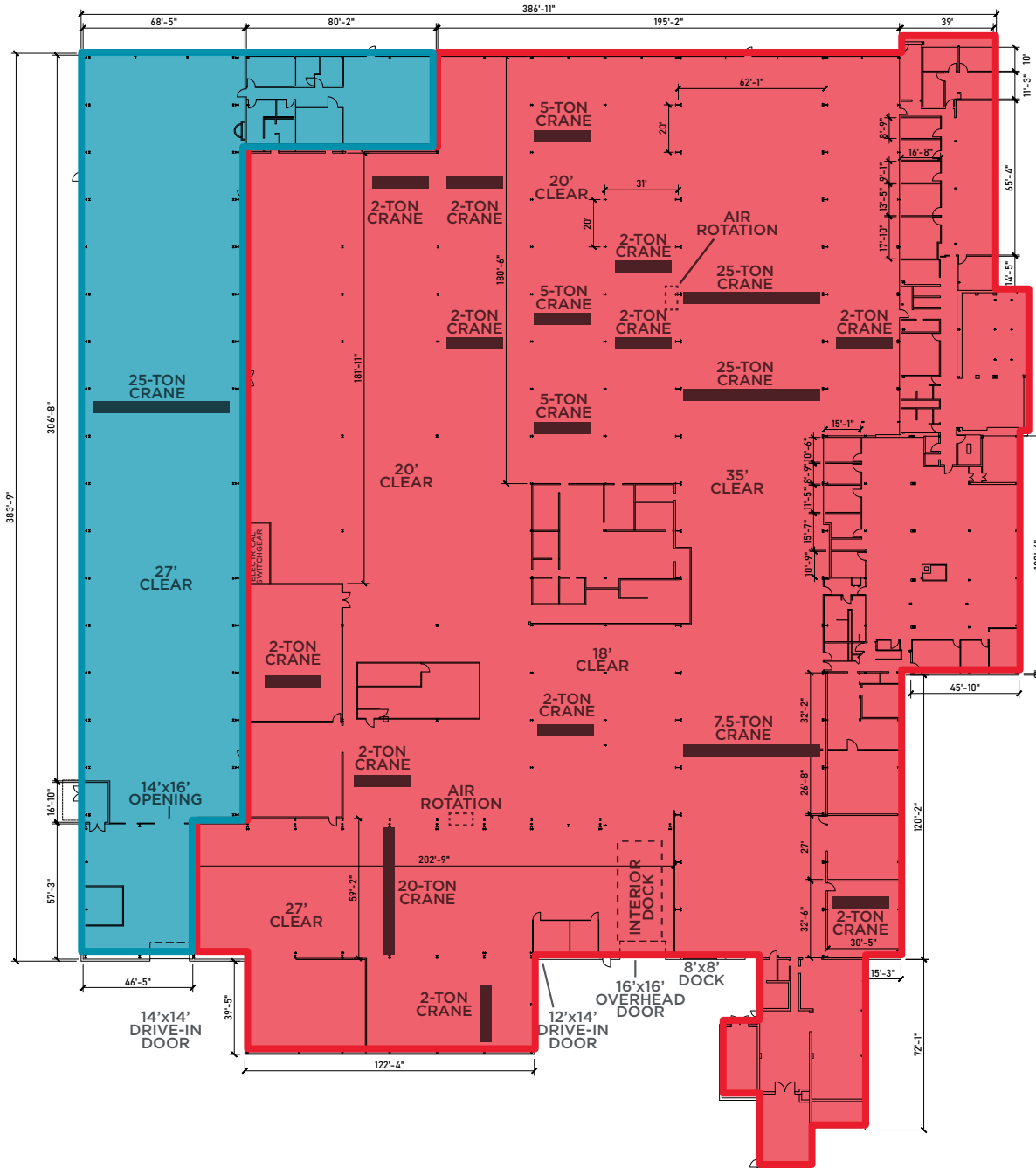

# PARCEL MAP



PROPERTY PHOTOS  
AERIAL



**EXTERIOR  
PHOTOS**



# INTERIOR PHOTOS

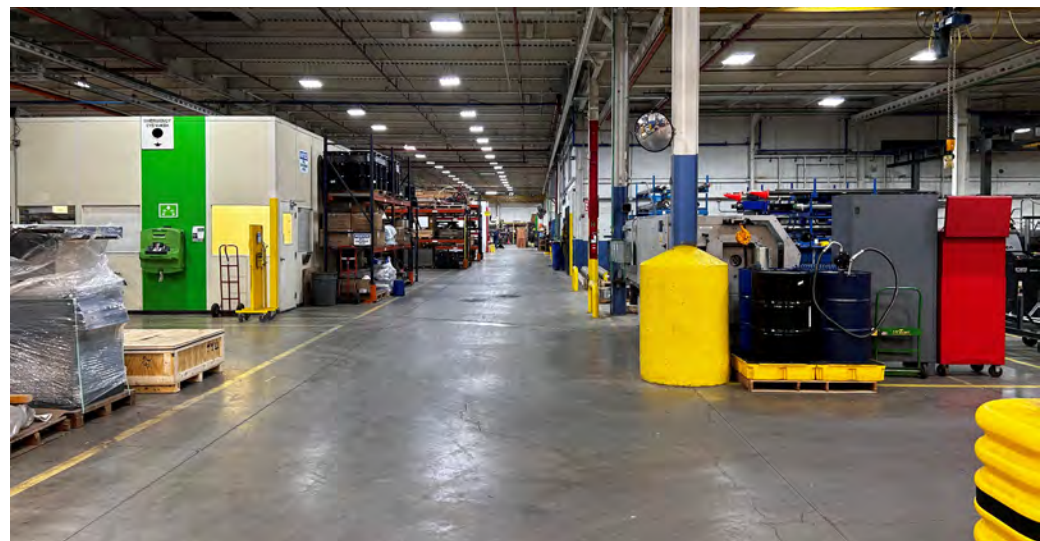
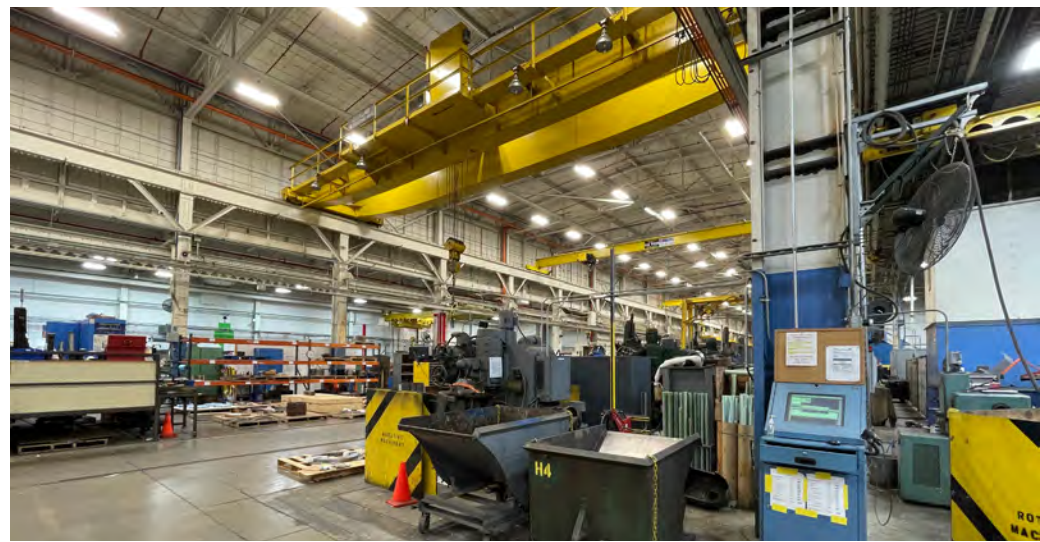

# LOCATION MAP

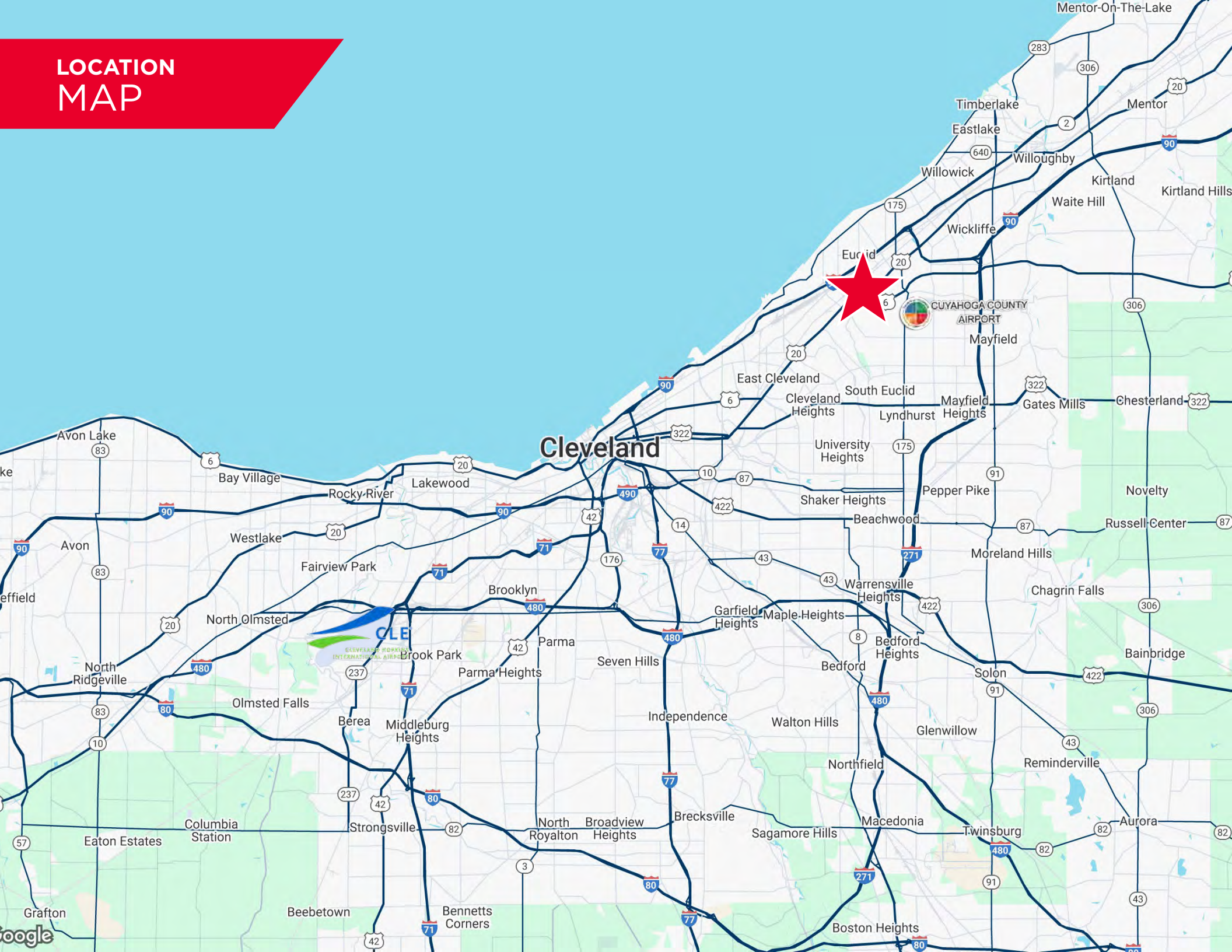



# AERIAL MAP

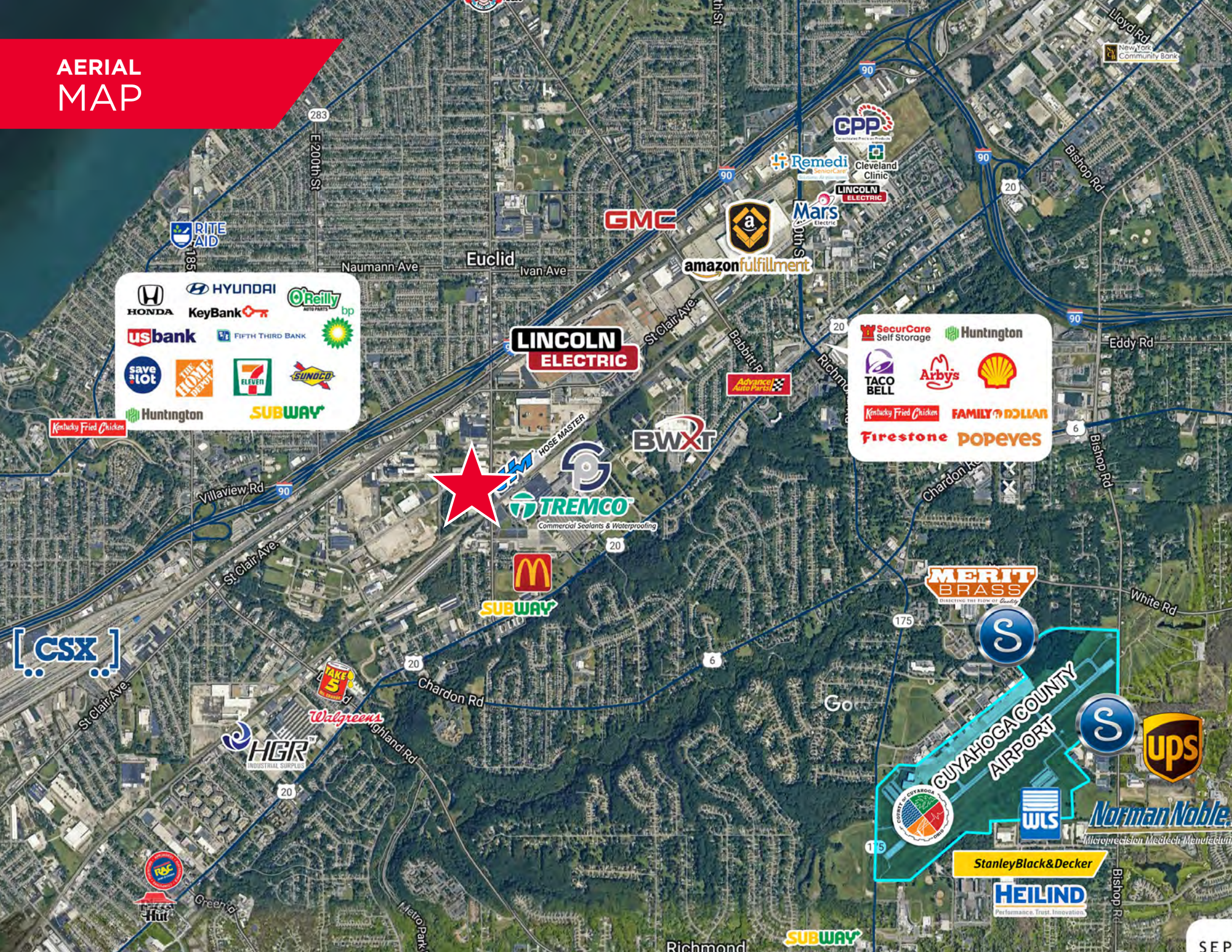

**HONDA** **HYUNDAI** **O'Reilly** **KeyBank** **usbank** **FIFTH THIRD BANK** **save a lot** **THE HOME DEPOT** **7 ELEVEN** **SUNOCO** **Huntington** **SUBWAY**

**SecurCare** **Huntington** **TACO BELL** **Arby's** **Shell** **Kentucky Fried Chicken** **FAMILY DOLLAR** **Firestone** **POPEYES**

**LINCOLN ELECTRIC** **HOSE MASTER** **TREMCO** *Commercial Sealants & Waterproofing*

**MERIT BRASS** **ups** **Norman Noble** *Microprecision Medtech Manufacturing* **StanleyBlack&Decker** **HEILIND** *Performance. Trust. Innovation.*

[CSX]

# 1250 E. 222<sup>nd</sup> Street

## Euclid, Ohio 44117

### **ELIOT KIJEWSKI, SIOR**

Principal  
+1 216 525 1487  
ekijewski@crescorealestate.com

### **GEORGE J. POFOK, CCIM, SIOR**

Principal  
+1 216 525 1469  
gpofok@crescorealestate.com

### **JOSEPH V. BARNA, SIOR**

Principal  
+1 216 525 1464  
jbarna@crescorealestate.com

### **SIMON CAPLAN, SIOR**

Senior VP & Partner Emeritus  
+1 216 525 1472  
scaplan@crescorealestate.com

### **RYAN CURTIN**

Associate  
+1 216 232 4105  
rcurtin@crescorealestate.com

**FOR FULL OFFERING, PLEASE SIGN AND RETURN THE CONFIDENTIALITY AGREEMENT**

### **CUSHMAN & WAKEFIELD CRESCO REAL ESTATE**

6100 Rockside Woods Blvd, Suite 200  
Cleveland, Ohio 44131  
+1 216 525 1200



**CRESCOREALESTATE.COM**

*Independently Owned and Operated / A Member of the Cushman & Wakefield Alliance*

Cushman & Wakefield Copyright 2024. No warranty or representation, express or implied, is made to the accuracy or completeness of the information contained herein, and same is submitted subject to errors, omissions, change of price, rental or other conditions, withdrawal without notice, and to any special listing conditions imposed by the property owner(s). As applicable, we make no representation as to the condition of the property (or properties) in question.