

10131

BUBB ROAD, CUPERTINO, CA

OFFICE / R&D | ±18,000 SF FOR LEASE



SCOTT DEVER
scott.dever@cushwake.com
+1 415 425 1735
LIC. 01890552



HIGHLIGHTS

±18,000 SF

- New Best in Class Creative Office/R&D Interiors
- Ample Glass Line and Natural Light Via Skylights
- Power: 1,600 Amps | 120/208 Volt | 3-phase
- Cooling: 82.5 Tons
- Parking Ratio: ±3.3/1,000 SF

10131 BUBB ROAD, CUPERTINO, CA

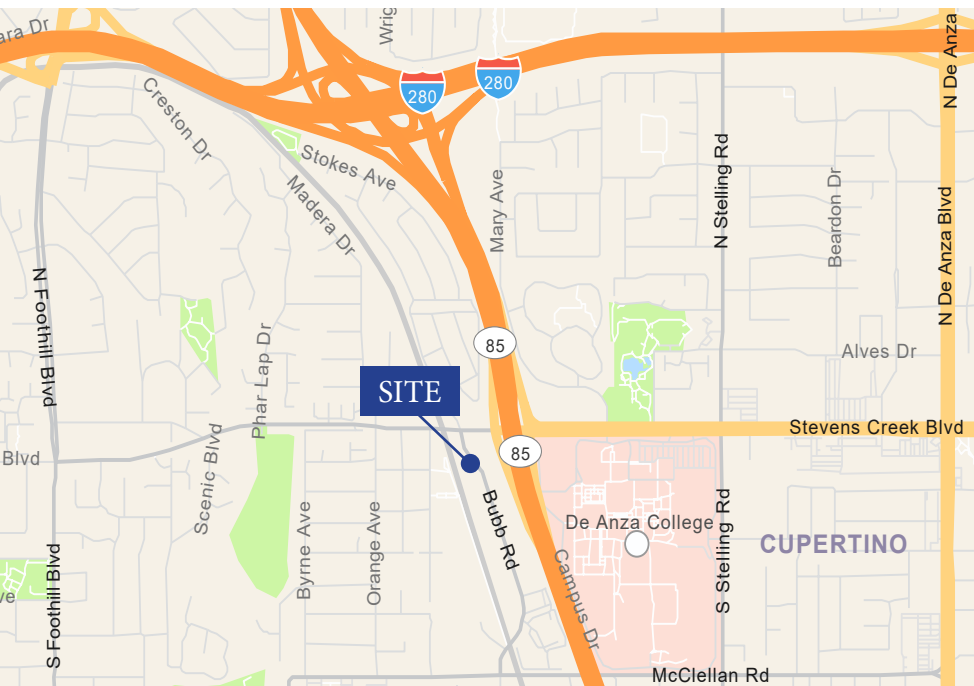

FLOOR PLAN

±18,000 SF

10131 BUBB ROAD, CUPERTINO, CA

AS-BUILT PLAN

Future
Roll Up
Door



OFFICE	14
CONFERENCE	5
FOCUS	9
HUDDLE	5



FLOOR PLAN

±18,000 SF

10131 BUBB ROAD, CUPERTINO, CA

HYPOTHETICAL TECH LAYOUT

Future
Roll Up
Door

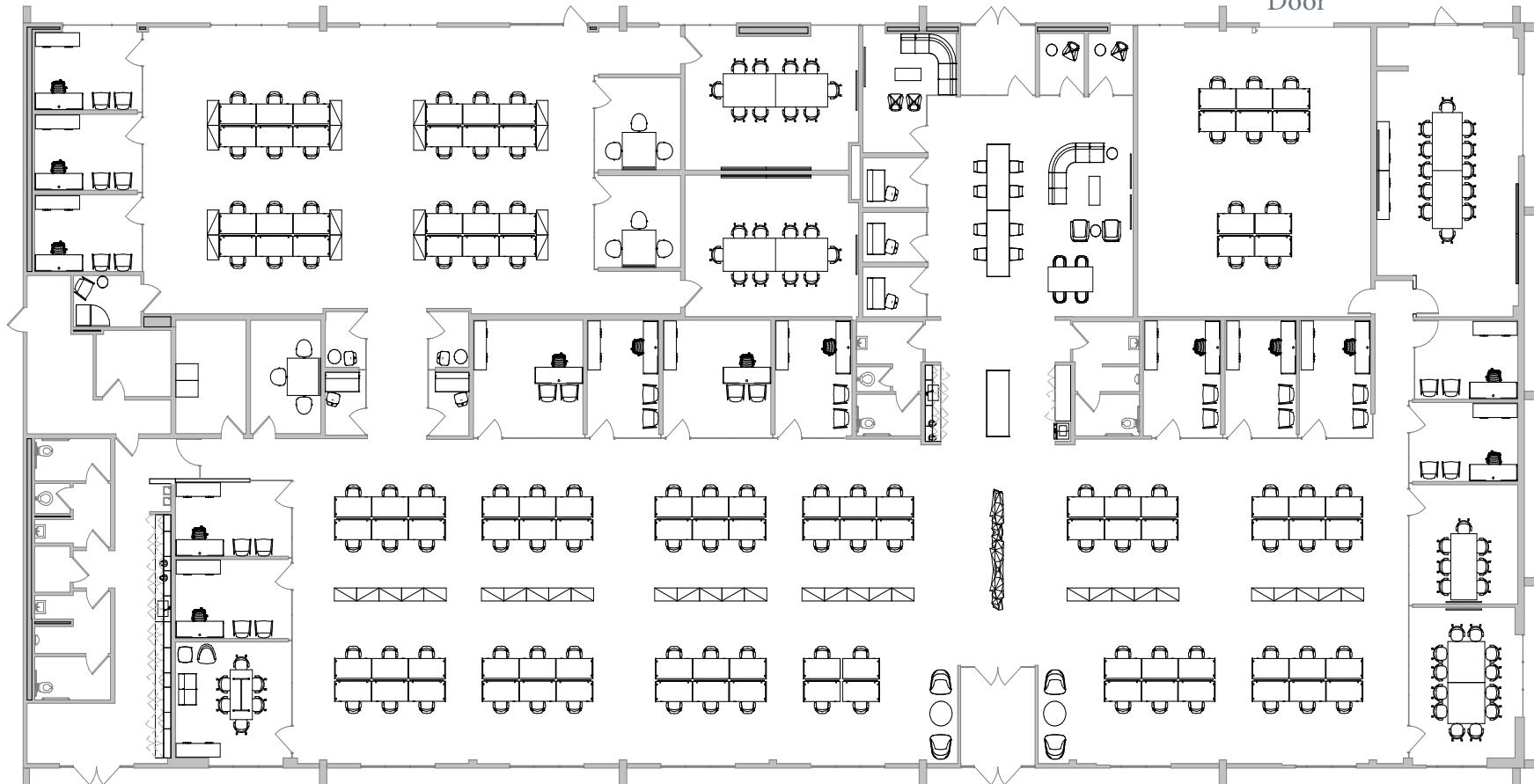

OFFICE	14	BREAK ROOM	1
BENCH	104	CONFERENCE	5
TOTAL	118	FOCUS	9
		HUDDLE	5
		OPEN COLLABORATION	3



FLOOR PLAN

±18,000 SF

10131 BUBB ROAD, CUPERTINO, CA

HYPOTHETICAL R&D LAYOUT

Future
Roll Up
Door

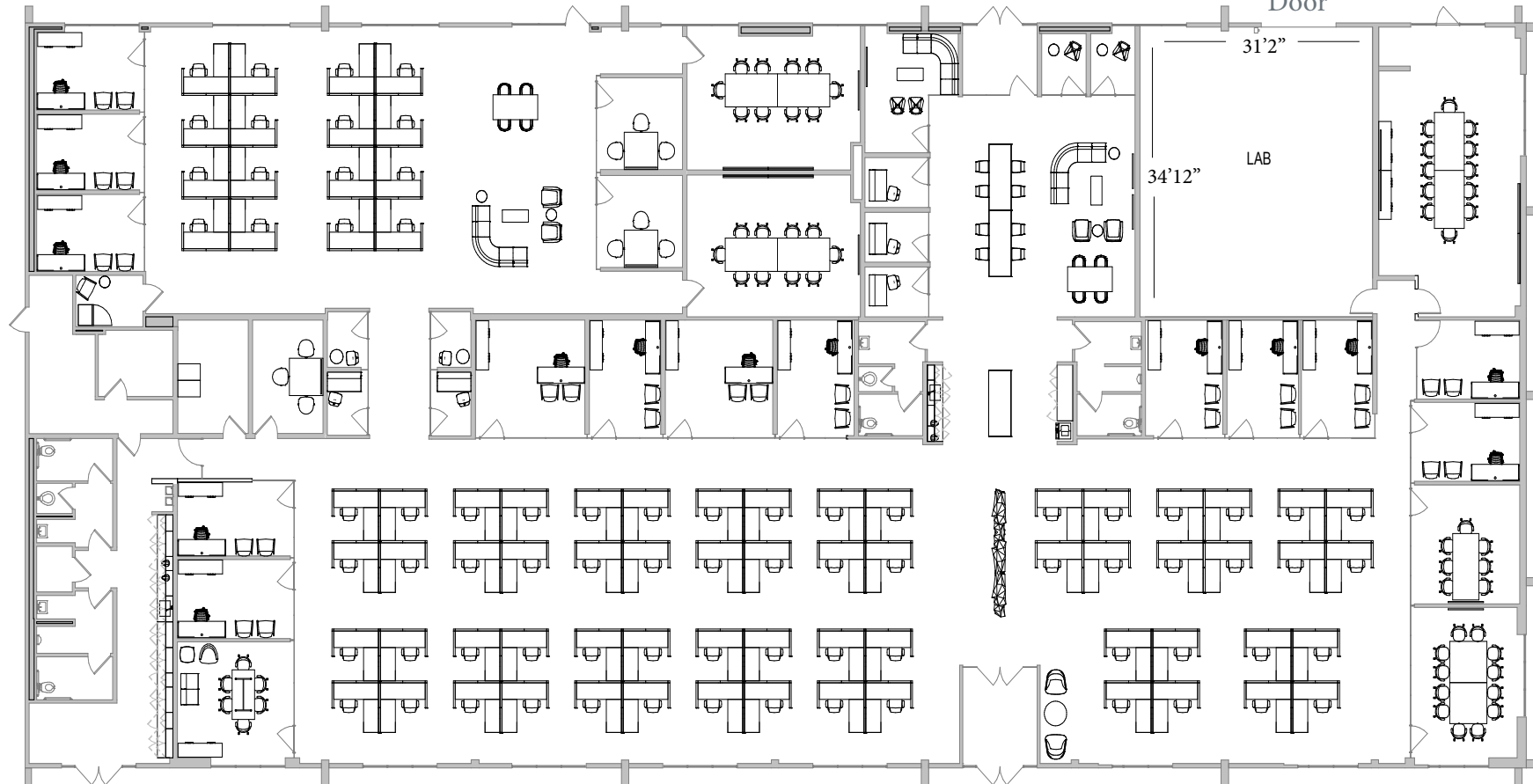

OFFICE 14
 WORKSTATION 76
 TOTAL 90

BREAK ROOM 1
 CONFERENCE 5
 FOCUS 9
 HUDDLE 5
 OPEN COLLABORATION 3
 LAB 1

VIEW 3D WALKTHROUGH

