

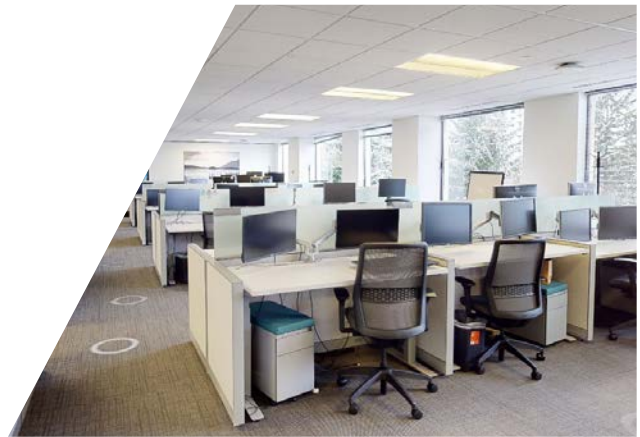

10,737 SF FOR SUBLEASE

# PLAZA CENTER

10900 NE 8th St, Suite 500  
Bellevue, WA 98004







# FEATURES

- Available now
- Master lease term through 9/30/2024
- Furniture available
- Mostly open tech space with 79 workstations, 2 phone booths, 2 private offices, 3 meeting rooms, 3 conference rooms, 2 team rooms, reception area, kitchenette, IT/server room, production/copy/print area, and storage
- Building amenities include bike storage, on-site banking, fitness center, and shower facilities.
- Call for rates



# FLOORPLAN

10,737 SF

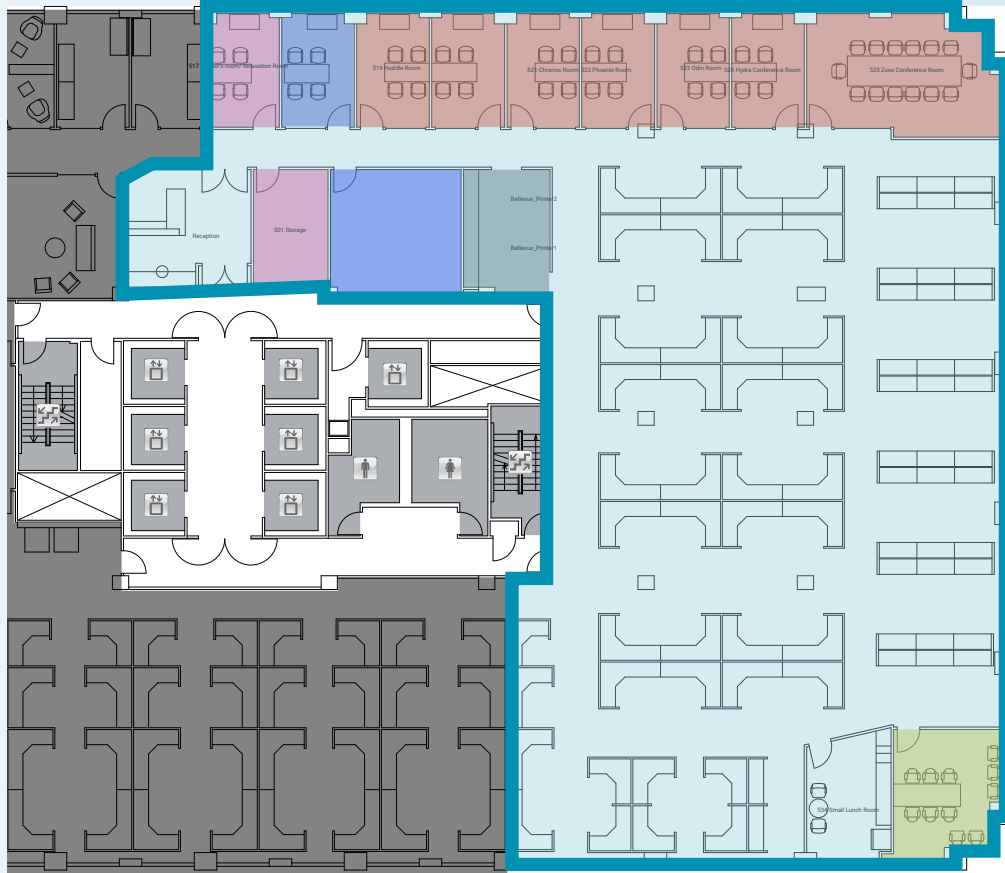

[VIRTUAL TOUR  
AVAILABLE HERE](#)

## CONTACT

Trevor Youngren

+1 206 521 0241

trevor.youngren@cushwake.com

Will Carroll

+1 206 521 0244

will.carroll@cushwake.com

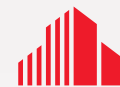

**CUSHMAN &  
WAKEFIELD**

©2023 Cushman & Wakefield. All rights reserved. The information contained in this communication is strictly confidential. This information has been obtained from sources believed to be reliable but has not been verified. NO WARRANTY OR REPRESENTATION, EXPRESS OR IMPLIED, IS MADE AS TO THE CONDITION OF THE PROPERTY (OR PROPERTIES) REFERENCED HEREIN OR AS TO THE ACCURACY OR COMPLETENESS OF THE INFORMATION CONTAINED HEREIN, AND SAME IS SUBMITTED SUBJECT TO ERRORS, OMISSIONS, CHANGE OF PRICE, RENTAL OR OTHER CONDITIONS, WITHDRAWAL WITHOUT NOTICE, AND TO ANY SPECIAL LISTING CONDITIONS IMPOSED BY THE PROPERTY OWNER(S). ANY PROJECTIONS, OPINIONS OR ESTIMATES ARE SUBJECT TO UNCERTAINTY AND DO NOT SIGNIFY CURRENT OR FUTURE PROPERTY PERFORMANCE.