

560

S. WINCHESTER BOULEVARD

SAN JOSE | CALIFORNIA



±9,410 SQUARE FEET | SANTANA ROW

EXPERTLY LEASED BY:



ERIK HALLGRIMSON

erik.hallgrimson@cushwake.com
P +1 408 615 3435
LIC #01274540

KELLY YODER

kelly.yoder@cushwake.com
P +1 408 615 3427
LIC # 01821117

STEVE HORTON

steve.horton@cushwake.com
P +1 408 615 3412
LIC # 01127340

PROUDLY OWNED BY:



560



560

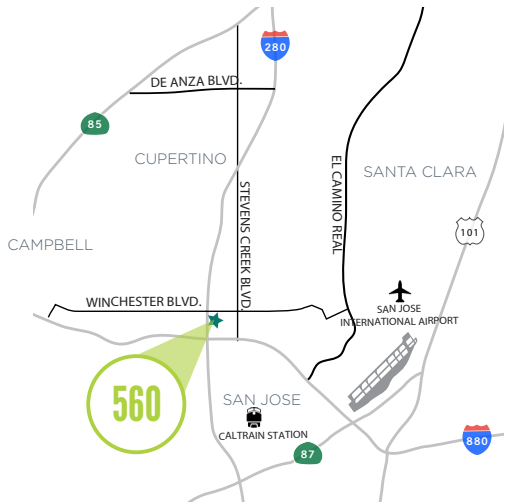
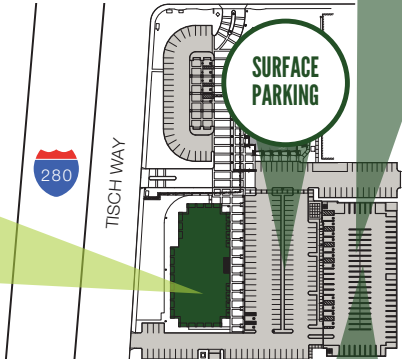

SITE PLAN / HIGHLIGHTS

±9,410 SF Available on the 2nd Floor
 ±3.3/1000 SF On-Site Surface & Structured Parking
 Solar Panels on Parking Structure Providing ±35% Offset of Building Electricity Consumption



560



ZAZIL COCINA MEXICANA



CIELO ROOFTOP WINE BAR



MESO MEDITERRANEAN



DUMPLING TIME



LB STEAK

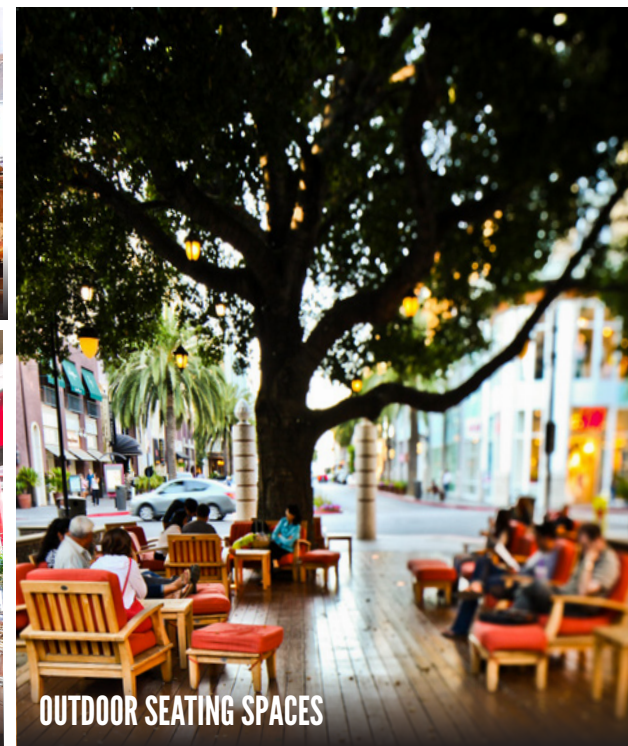

OUTDOOR SEATING SPACES

SANTANA ROW HIGHLIGHTS

Santana Row is the premier live, work and play destination in the South Bay
Convenient access to Highways 280, 880 and 101
Four miles from Downtown San Jose and six miles from San Jose International Airport

834 RESIDENCES | 70 SHOPS | 35 RESTAURANTS | SPAS & SALONS | HOTEL | FITNESS CENTER | MOVIE THEATER

FLOOR PLAN

560

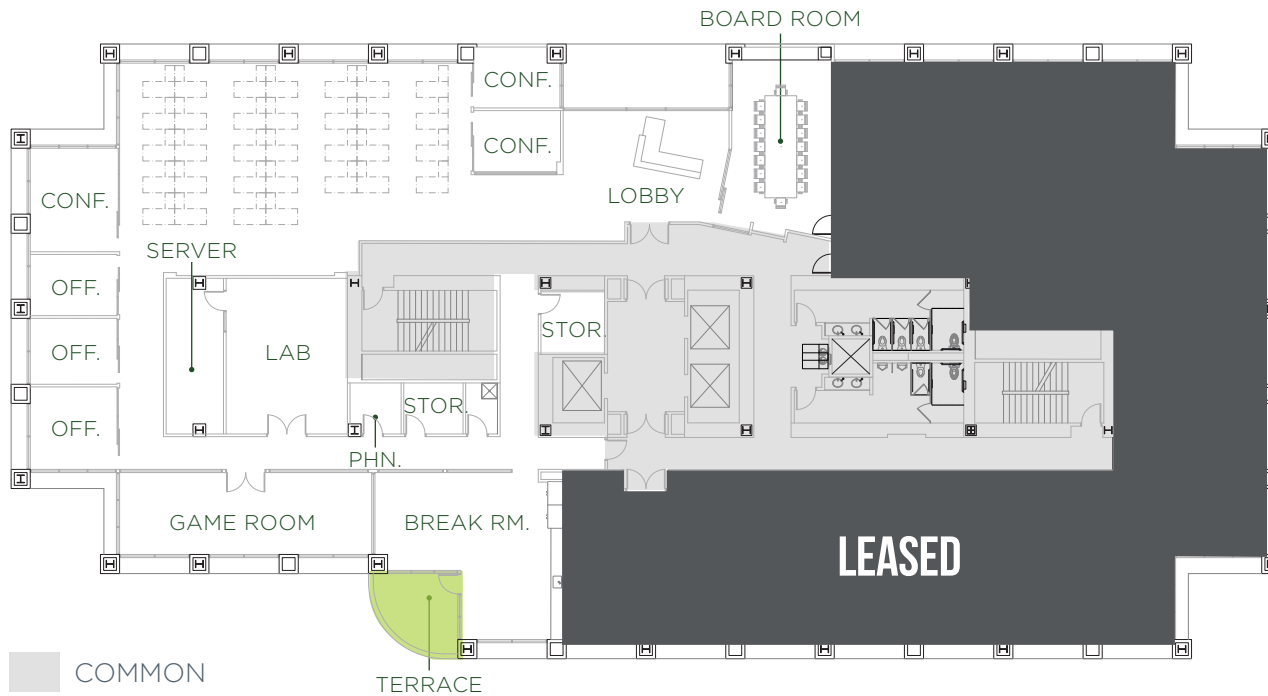

2ND FLOOR
±9,410 SF

- 32 Workstations
- 3 Offices
- 1 Board Room
- 3 Conference Rooms
- 1 Phone Room
- Breakroom
- 1 Game Room
- 1 Lab
- 1 Server Room

PLUG & PLAY



HYPOTHETICAL FLOOR PLAN

560



2ND FLOOR
±9,410 SF

- 46 Workstations
- 1 Board Room
- 3 Conference Rooms
- 3 Offices
- 1 Phone Room
- Break Room



VIEW VIRTUAL TOUR

560

S. WINCHESTER BOULEVARD

SAN JOSE | ±9,410 SQUARE FEET

ERIK HALLGRIMSON

erik.hallgrimson@cushwake.com
P +1 408 615 3435
LIC #01274540

KELLY YODER

kelly.yoder@cushwake.com
P +1 408 615 3427
LIC #01821117

STEVE HORTON

steve.horton@cushwake.com
P +1 408 615 3412
LIC #01127340

PROUDLY OWNED BY:



EXPERTLY LEASED BY:

