

PROPERTY HIGHLIGHTS

- \$16.75 NNN
- 9,475 SF Available
- Crown Signage Available
- Ample Parking
- Easy Freeway Access
- Proximity to South Towne Amenities
- 5/1,000 Parking



Justin Bailey

Director

+1 801 303 5493

justin.bailey@cushwake.com

170 South Main, Suite 1600
Salt Lake City, UT 84101
Main +1 801 322 2000
cushmanwakefield.com

Level Two

■ 9,475 RSF

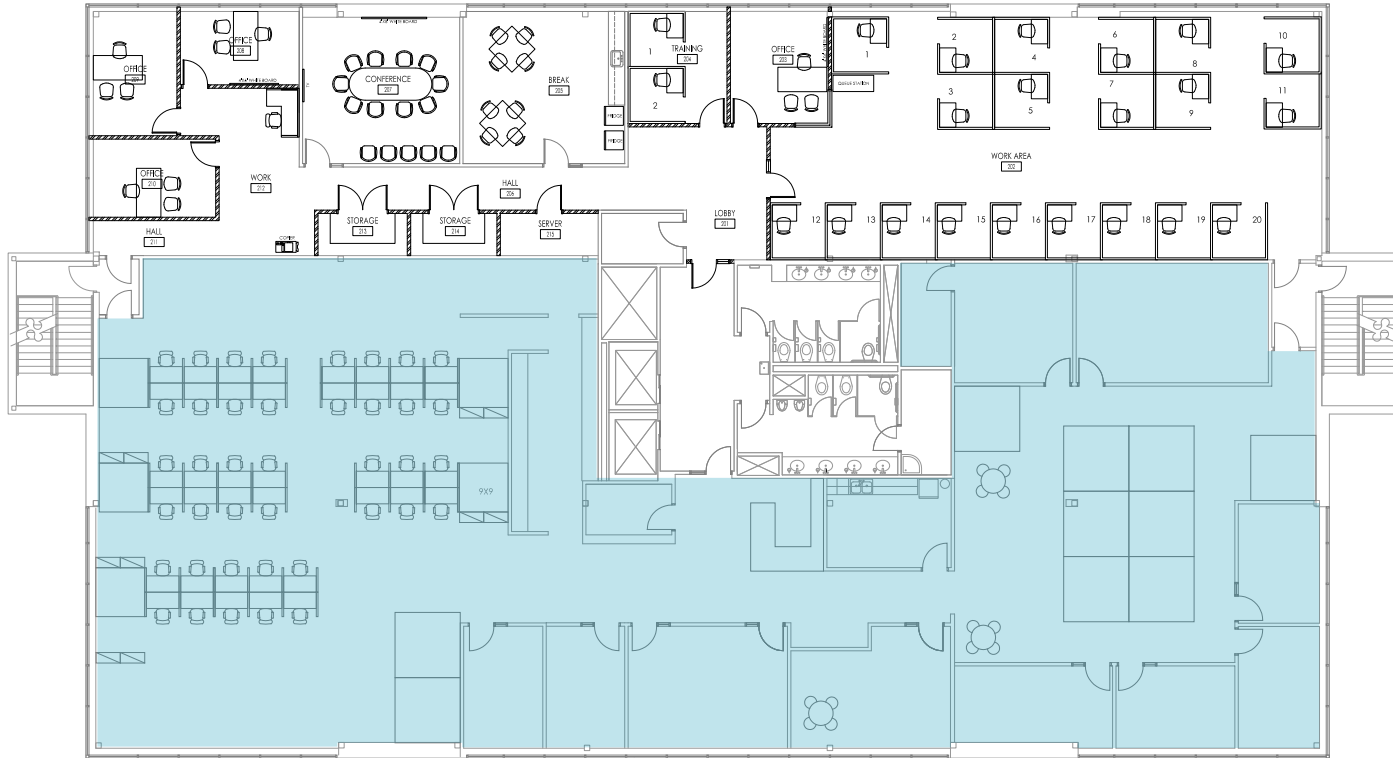

○ Level Two Floor Plan
Scale: none

Justin Bailey
Director
+1 801 303 5493
justin.bailey@cushwake.com

170 South Main, Suite 1600
Salt Lake City, UT 84101
Main +1 801 322 2000
cushmanwakefield.com



Justin Bailey
Director
+1 801 303 5493
justin.bailey@cushwake.com

170 South Main, Suite 1600
Salt Lake City, UT 84101
Main +1 801 322 2000
cushmanwakefield.com