

1415 THE ALAMEDA

SAN JOSE, CA



YOUR NAME HERE

±1,400 SF OF RETAIL AVAILABLE FOR LEASE

MIKE CONROY
+1 408 400 7061
mconroy@theeoniccompany.com
LIC #02046912

SHELBY SWANSON
+1 408 400 3879
sswanson@theeoniccompany.com
LIC #02075363

CLARK STEELE
+1 408 436 3653
clark.steele@cushwake.com
LIC #01995379

 the eonic company®

 CUSHMAN & WAKEFIELD

1415 THE ALAMEDA

SAN JOSE, CA

HIGHLIGHTS

- ±1,400 SF 1st Floor Retail
- High Identity Location on The Alameda
- Private Parking Stalls
- Neighboring Peet's, Zona Rosa, Hop & Vine and Orange Theory
- Nearby Whole Food's Market
- Gateway to Downtown San Jose
- Minutes to Diridon Station Caltrain

TRAFFIC COUNTS

- The Alameda 37,700 ADT

FLOOR PLAN

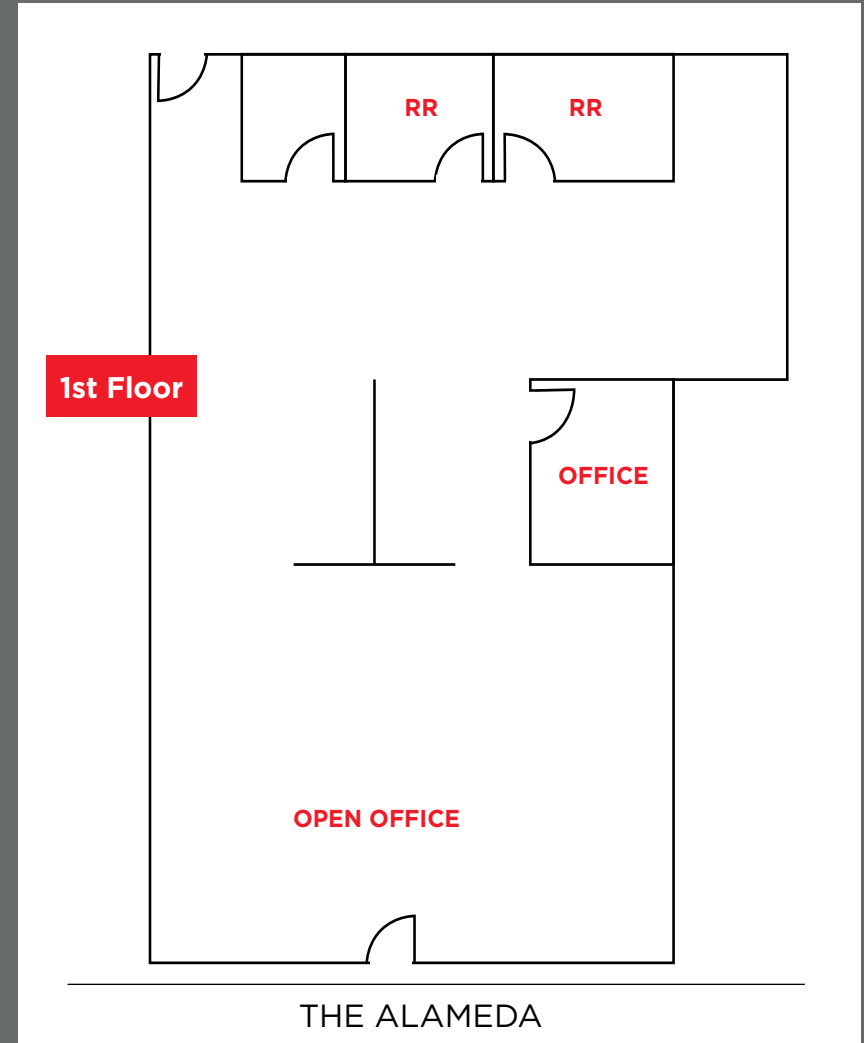

DEMOGRAPHICS

	ONE MILE	THREE MILES	FIVE MILES
 POPULATION	25,626	231,069	666,284
 AVG. HH INCOME	\$159,058	\$140,504	\$144,244
 TOTAL HOUSEHOLDS	10,418	87,127	230,080
 DAYTIME POPULATION	30,209	265,673	711,896

NEARBY RETAIL



1415 THE ALAMEDA

SAN JOSE, CA

MIKE CONROY
+1 408 400 7061
mconroy@theconiccompany.com
LIC #02046912

SHELBY SWANSON
+1 408 400 3879
sswanson@theconiccompany.com
LIC #02075363

CLARK STEELE
+1 408 436 3653
clark.steele@cushwake.com
LIC #01995379

