



AVAILABLE FOR LEASE

1525 Meridian Ave., Unit 105 & 106

San Jose, CA

±3,076 SF Retail/Office/Medical
Divisible to ±1,339 SF & ±1,737 SF

Property Highlights:

- Unit 105: ±1,737 SF
- Unit 106: ±1,339 SF
- Max Contiguous: ±3,076 SF
- Excellent Willow Glen Location
- Great Street Visibility/Identity
- Ample Parking
- Easy Access to I-280 & Hwy 17
- 2022 Traffic Count (ADT)
Meridian Ave @ Hamilton Ave: 46,000 Cars

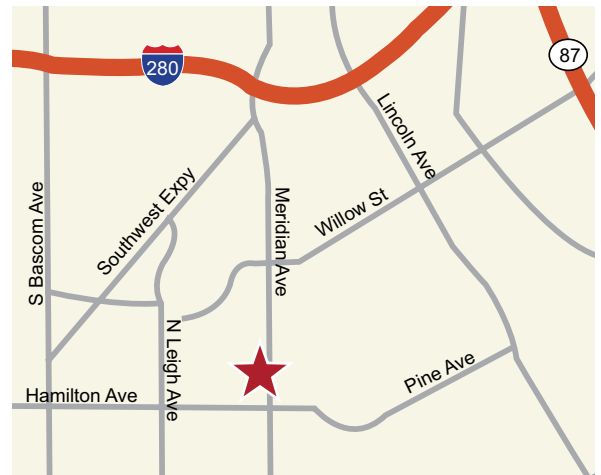

2022 Demographics

DISTANCE	2-MILE	3-MILE	5-MILE
Population	106,851	240,881	661,195
AVG HH Income	\$186,107	\$176,529	\$170,675

For more information, contact:

John Brackett
Managing Director
Cushman & Wakefield
408.309.3300
john.brackett@cushwake.com
LIC #00906947

300 Santana Row, Fifth Floor
San Jose, California 95128
ph: 408.615.3400
fx: 408.615.3444
cushmanwakefield.com

FLOOR PLAN

UNIT 105	±1,737 SF
UNIT 106	±1,339 SF
UNITS 105 + 106	±3,076 SF

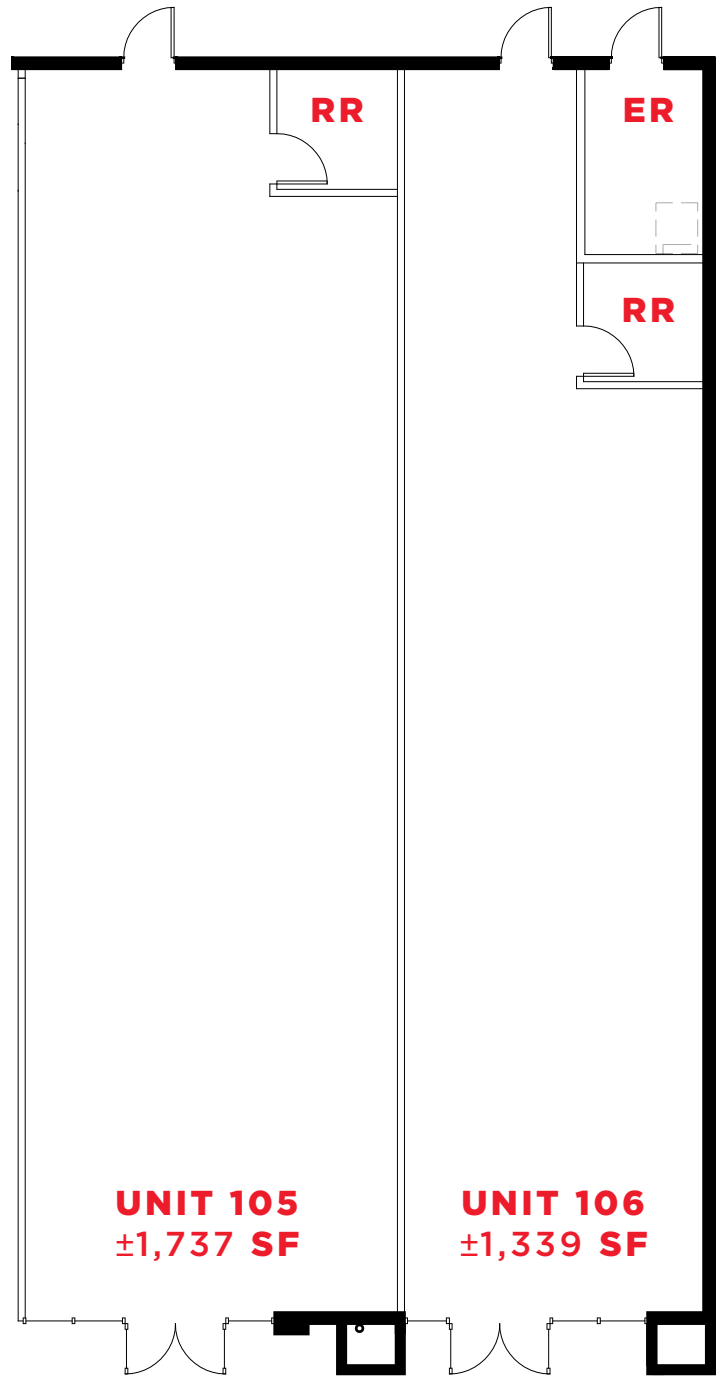

UNIT 105
±1,737 SF

UNIT 106
±1,339 SF

NOT TO SCALE

BUILDING PLAN

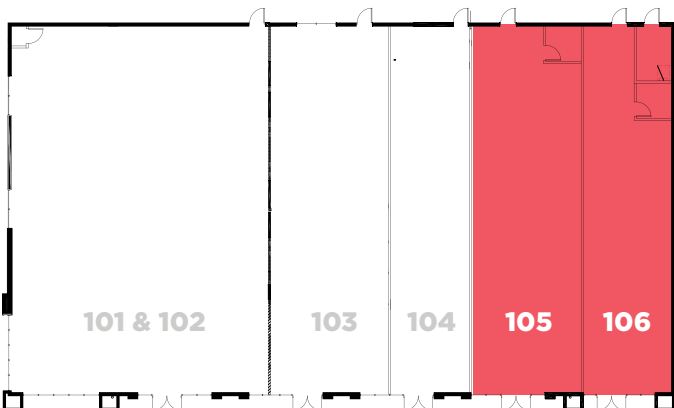

For more information, contact:
John Brackett | Managing Director
Cushman & Wakefield
 408.309.3300 | john.brackett@cushwake.com
 LIC #00906947

©2023 Cushman & Wakefield. All rights reserved. The information contained in this communication is strictly confidential. This information has been obtained from sources believed to be reliable but has not been verified. NO WARRANTY OR REPRESENTATION, EXPRESS OR IMPLIED, IS MADE AS TO THE ACCURACY OR COMPLETENESS OF THE INFORMATION CONTAINED HEREIN, AND SAME IS SUBMITTED SUBJECT TO ERRORS, OMISSIONS, CHANGE OF PRICE, RENTAL OR OTHER CONDITIONS, WITHDRAWAL WITHOUT NOTICE, AND TO ANY SPECIAL LISTING CONDITIONS IMPOSED BY THE PROPERTY OWNER(S). ANY PROJECTIONS, OPINIONS OR ESTIMATES ARE SUBJECT TO UNCERTAINTY AND DO NOT SIGNIFY CURRENT OR FUTURE PROPERTY PERFORMANCE.